



The Timken Company

4500 Mt Pleasant St. NW

N. Canton, OH 44720

Phone: (234) 262-3000

E-Mail: CustomerCAD@timken.com • **Web site:** www.timken.com

Bearing Unit - Adapter Sleeve UKP217 - H2317, UKP 200 Pillow Block Mounted Bearings - Adapter Sleeve Locking

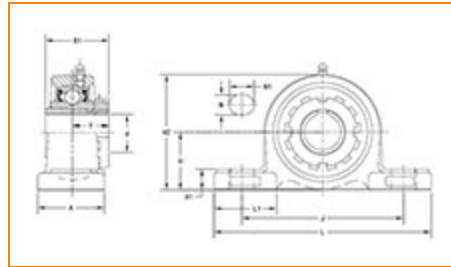

[Specifications](#) | [Dimensions](#) | [Basic Load Ratings](#)

Specifications

Bearing Unit - Adapter Sleeve	UK217 - H2317
Shaft Size d	75 mm
Adapter Sleeve Number¹	H2317
Locking Style	Adapter Sleeve Locking
Housing Construction	Two-Bolt Pillow Block

Dimensions

Base to Center Height H	95.2 mm 3.748 in
Total Length L	310 mm 12.205 in
Housing Width A	83 mm 3.268 in



Bolt Hole Spacing J	247 mm 9.724 in
Bolt Hole Size N	25 mm 0.984 in
Bolt Hole Length N1	40 mm 1.575 in
Foot Height H1	32 mm
Total Height H2	185 mm 7.283 in
Dimension L1	87 mm 3.425 in
Center of Bearing from End Y	46.5 mm 1.831 in
Dimension B1	82 mm 3.228 in

Basic Load Ratings

Static Load Rating	61900 N 13916 lbf
Dynamic Load Rating	84000 N 18884 lbf

¹ Purchase the Adapter Sleeve separately

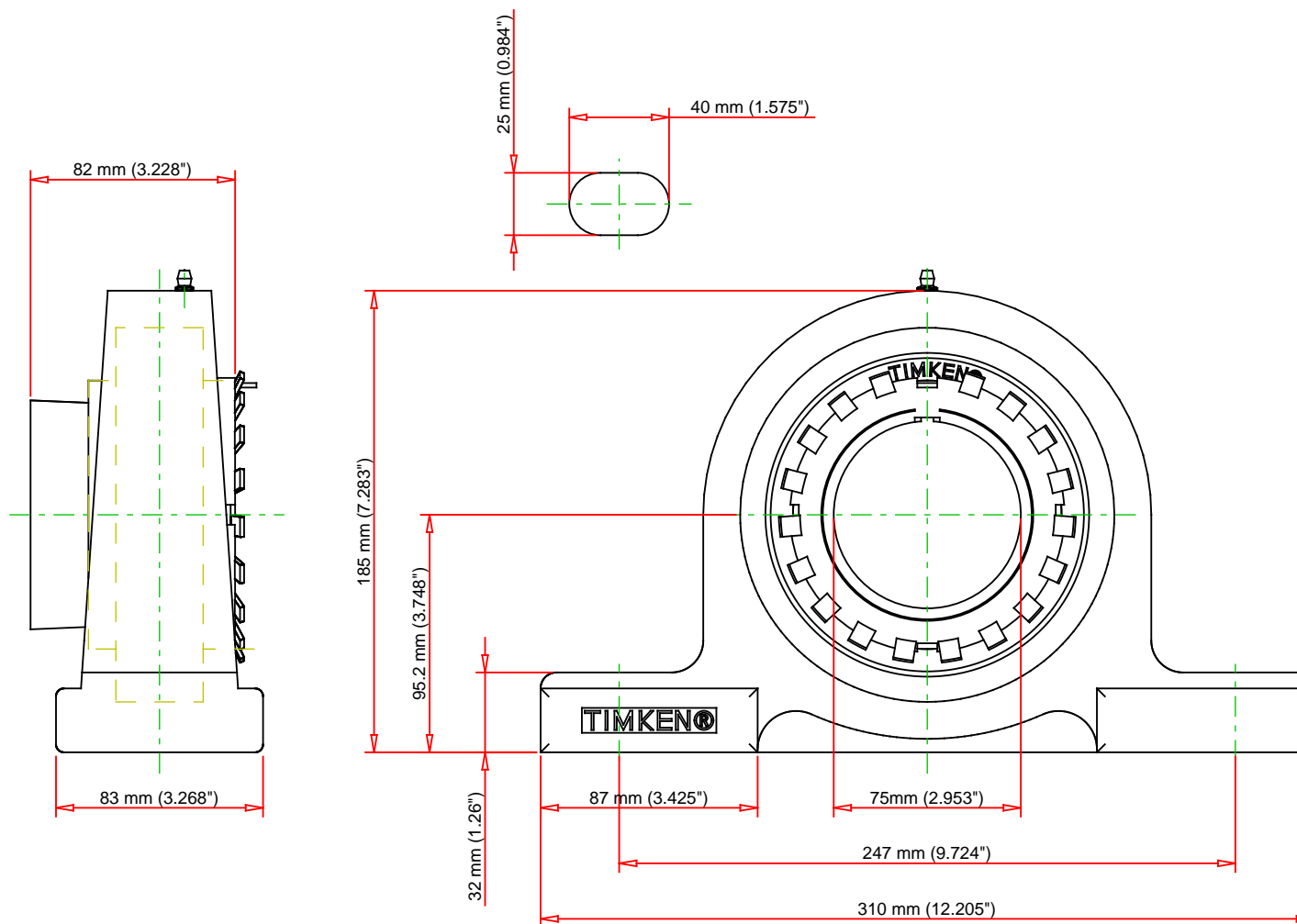

Note: Adapter sold separately

	Bearing Number	UK217 - H2317					UKP217 - H2317 UKP 200 Pillow Block Mounted Bearings - Adapter Sleeve Locking
	Load Ratings - C _r	18884	lbf	84000	N		
	Load Ratings - C _{0r}	13916	lbf	61900	N		
	Weight	24.7	lb	11.2	kg		
						THE TIMKEN COMPANY NORTH CANTON, OHIO USA	FOR DISCUSSION ONLY
Every reasonable effort has been made to ensure the accuracy of the information contained in this writing, but no liability is accepted for errors, omissions or for any other reason.							