



The Timken Company

4500 Mt Pleasant St. NW

N. Canton, OH 44720

Phone: (234) 262-3000

E-Mail: CustomerCAD@timken.com • **Web site:** www.timken.com

Part Number UCFL307, UCFL 300 Two-Bolt Flanged Mounted Bearings - Set Screw Locking

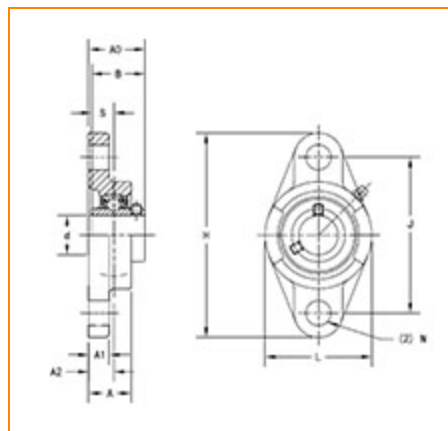

[Specifications](#) | [Dimensions](#) | [Basic Load Ratings](#)

Specifications

Bearing Number	UC307
Shaft Size d	35 mm
Locking Style	Set Screw Locking
Housing Construction	Two-Bolt Flange

Dimensions

Total Length H	185 mm
Total Height L	100 mm
Housing Width A	36 mm
Bolt Hole Spacing J	141 mm
Bolt Hole Size N	23 mm



Flange Thickness A1	16 mm
Center of Bearing from Housing End A2	20 mm
Inner Ring Width B	48 mm
Center of Bearing from Bearing End S	19 mm
Dimension A0	49 mm
Bolt Size	M20

Basic Load Ratings

Static Load Rating	19300 N
Dynamic Load Rating	33400 N

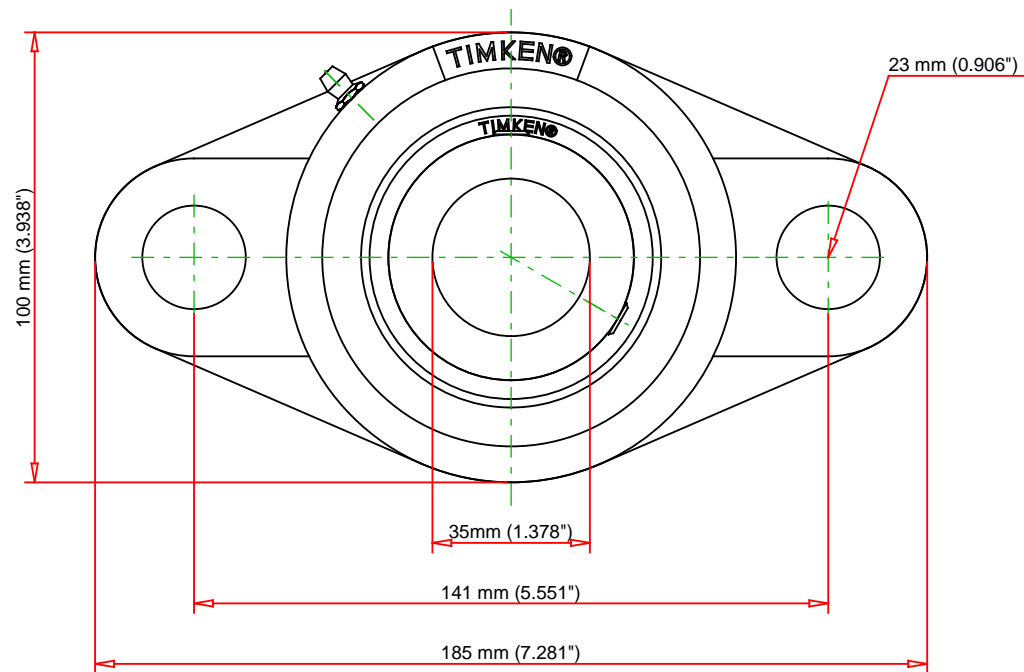
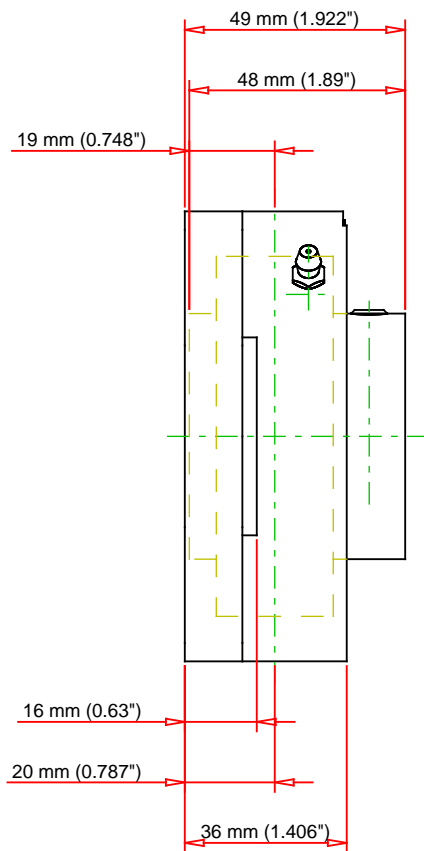

Bearing Number	UC307			
Load Ratings - C _r	7509	lbf	33400	N
Load Ratings - C _{0r}	4339	lbf	19300	N
Weight	4	lb	1.8	kg
Bolt Size	M20			

TIMKEN

THE TIMKEN COMPANY
NORTH CANTON, OHIO USA

UCFL307
UCFL 300 Two-Bolt Flanged Mounted
Bearings - Set Screw Locking

Every reasonable effort has been made to ensure the accuracy of the information contained in this writing, but no liability is accepted for errors, omissions or for any other reason.

FOR DISCUSSION ONLY