



**LOCKNUT-SOCKET-KM2** [🔗](#)

Locknut socket wrench

for locknuts and precision locknuts

Technical information

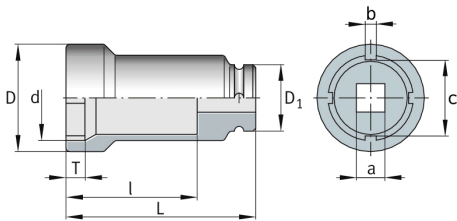

Dimensions

d	25.4 mm	
D	33 mm	
D <sub>1</sub>	30 mm	
L	82 mm	
l	65 mm	
T	6 mm	
a	1/2"	Square (inch)
b	3.5 mm	
c	21.6 mm	
≈m	0.2 kg	Weight

Additional information

KM2	suitable for locknuts
1 pc. socket wrench with locking pin and rubber washer	included in delivery