



The Timken Company

4500 Mt Pleasant St. NW

N. Canton, OH 44720

Phone: (234) 262-3000

E-Mail: CustomerCAD@timken.com • **Web site:** www.timken.com

Part Number UCFL306, UCFL 300 Two-Bolt Flanged Mounted Bearings - Set Screw Locking

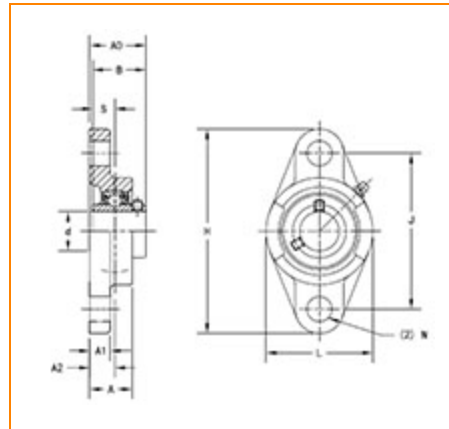

[Specifications](#) | [Dimensions](#) | [Basic Load Ratings](#)

Specifications

Bearing Number	UC306
Shaft Size d	30 mm
Locking Style	Set Screw Locking
Housing Construction	Two-Bolt Flange

Dimensions

Total Length H	180 mm 7.094 in
Total Height L	90 mm 3.531 in



Housing Width A	32 mm 1.25 in
Bolt Hole Spacing J	134 mm 5.276 in
Bolt Hole Size N	23 mm 0.906 in
Flange Thickness A1	15 mm 0.591 in
Center of Bearing from Housing End A2	18 mm 0.709 in
Inner Ring Width B	43 mm 1.693 in
Center of Bearing from Bearing End S	17 mm 0.669 in
Dimension A0	44 mm 1.734 in
Bolt Size	M20

Basic Load Ratings

Static Load Rating	15000 N 3372 lbf
Dynamic Load Rating	26700 N 6002 lbf

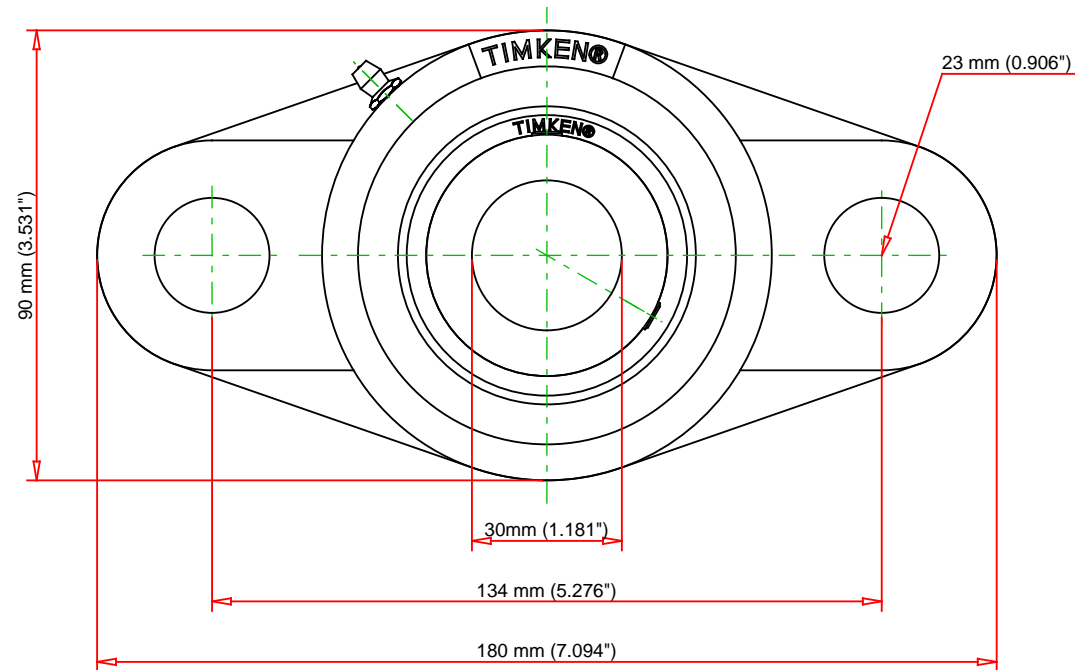
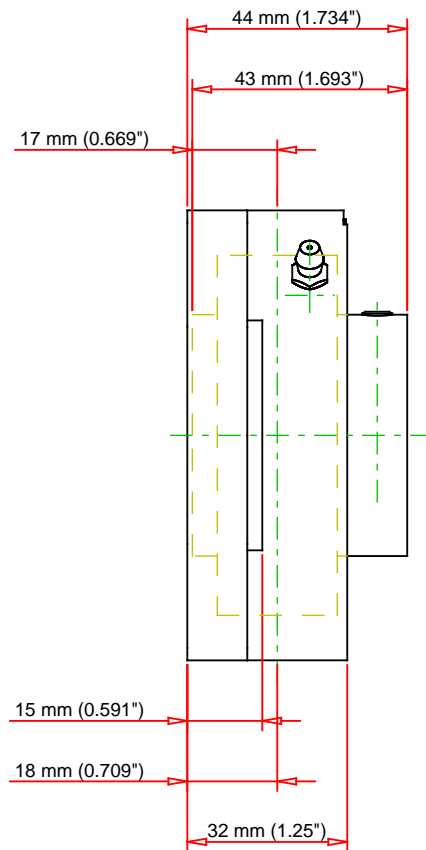

Bearing Number	UC306			
Load Ratings - C _r	6002	lbf	26700	N
Load Ratings - C _{0r}	3372	lbf	15000	N
Weight	3.3	lb	1.5	kg
Bolt Size	M20			

TIMKEN

THE TIMKEN COMPANY
NORTH CANTON, OHIO USA

UCFL306
UCFL 300 Two-Bolt Flanged Mounted
Bearings - Set Screw Locking

Every reasonable effort has been made to ensure the accuracy of the information contained in this writing, but no liability is accepted for errors, omissions or for any other reason.

FOR DISCUSSION ONLY