



The Timken Company

4500 Mt Pleasant St. NW

N. Canton, OH 44720

Phone: (234) 262-3000

E-Mail: CustomerCAD@timken.com • **Web site:** www.timken.com

Part Number UCFL305, UCFL 300 Two-Bolt Flanged Mounted Bearings - Set Screw Locking

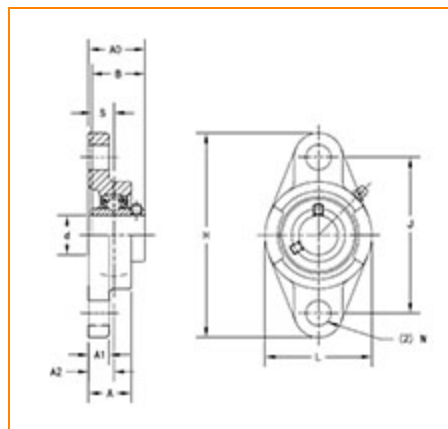

[Specifications](#) | [Dimensions](#) | [Basic Load Ratings](#)

Specifications

Bearing Number	UC305
Shaft Size d	25 mm
Locking Style	Set Screw Locking
Housing Construction	Two-Bolt Flange

Dimensions

Total Length H	150 mm 5.906 in
Total Height L	80 mm 3.156 in



Housing Width A 29 mm
1.156 in

Bolt Hole Spacing J 113 mm
4.449 in

Bolt Hole Size N 19 mm
0.748 in

Flange Thickness A1 13 mm
0.512 in

Center of Bearing from Housing End A2 16 mm
0.63 in

Inner Ring Width B 38 mm
1.496 in

Center of Bearing from Bearing End S 15 mm
0.591 in

Dimension A0 39 mm
1.531 in

Bolt Size M16

Basic Load Ratings

Static Load Rating 10900 N
2450 lbf

Dynamic Load Rating 21200 N
4766 lbf

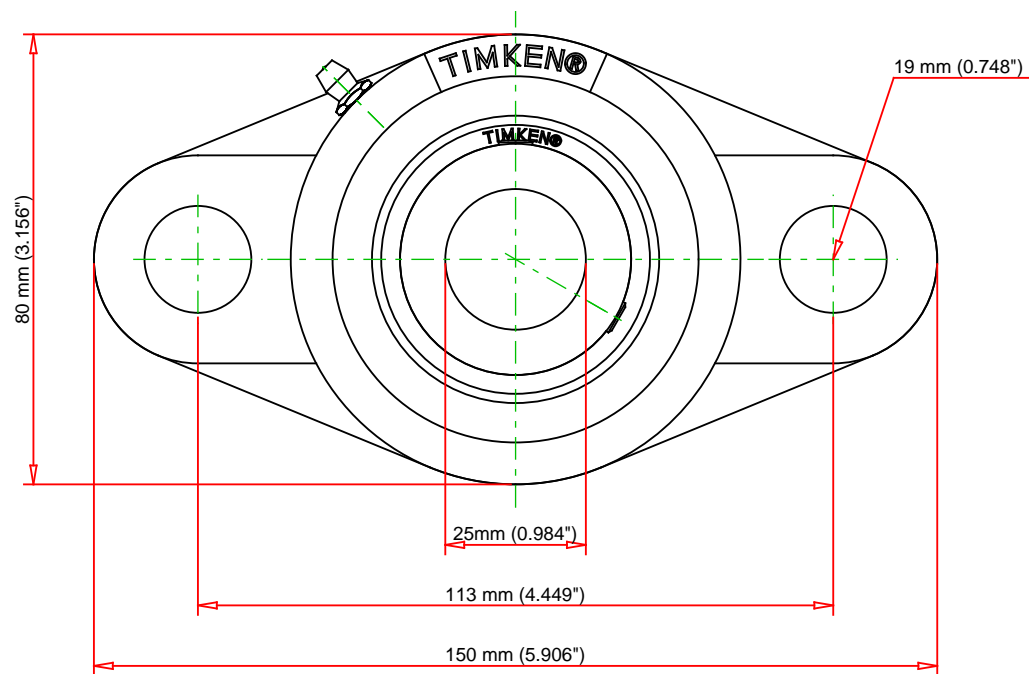
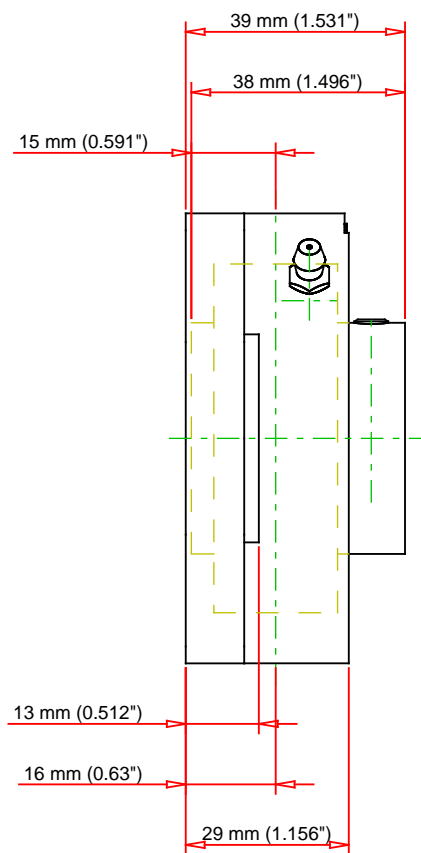

Bearing Number	UC305			
Load Ratings - C _r	4766	lbf	21200	N
Load Ratings - C _{0r}	2450	lbf	10900	N
Weight	2.4	lb	1.1	kg
Bolt Size	M16			

TIMKEN

THE TIMKEN COMPANY
NORTH CANTON, OHIO USA

UCFL305
UCFL 300 Two-Bolt Flanged Mounted
Bearings - Set Screw Locking

Every reasonable effort has been made to ensure the accuracy of the information contained in this writing, but no liability is accepted for errors, omissions or for any other reason.

FOR DISCUSSION ONLY