

Preparation of compressed air ► Maintenance units and components

3/2-directional valve, electrically operated, Series AS3-SOV-...-POS

► With integrated sensor ST6 ► G 3/8 - G 1/2 ► pipe connection



00133928_c

Version	Poppet valve, Can be assembled into blocks
Nominal flow	4500 l/min
Nominal flow, 1►2	4500 l/min
Nominal flow, 2►3	3200 l/min
Working pressure min./max.	3 bar / 10 bar
Medium	Compressed air
	Neutral gases
Medium temperature min./max.	-10°C / +50°C
Ambient temperature min./max.	-10°C / +50°C
Sealing principle	Soft sealing
Max. particle size	25 µm
Materials:	
Housing	Polyamide
Front plate	Acrylonitrile butadiene styrene
Seals	Acrylonitrile butadiene rubber
Threaded bushing	Die cast zinc



Technical Remarks

- The pressure dew point must be at least 15 °C under ambient and medium temperature and may not exceed 3 °C.
- Can be used in circuits with increased efficiency.
- An ST6 sensor (contactless) is used to detect the switching position in the non-actuated state (position: exhaust).
- The sensor signal is visible on the front of the cover

Operating voltage	Power consumption
DC	DC
	W
24 V	2

3/2-directional valve, electrically operated, Series AS3-SOV-...-POS

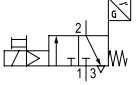
► With integrated sensor ST6 ► G 3/8 - G 1/2 ► pipe connection

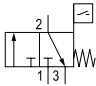
	MO	Compressed air connection			Operating voltage	Power consumption	Electr. connection	Part No.
		Input	Output	Exhaust	DC	DC	Pilot valve	
						[W]		
		G 3/8	G 3/8				Plug ISO 15217, form C	R412007359
		G 3/8	G 3/8				Plug ISO 15217, form C	R412007336
		G 3/8	G 3/8				Plug ISO 15217, form C	R412007377
		G 3/8	G 3/8				Socket M12x1	R412007353
		G 3/8	G 3/8				Socket M12x1	R412007355
		G 3/8	G 3/8	G 1/2	24 V	2	Socket M12x1	R412007396
		G 1/2	G 1/2				Plug ISO 15217, form C	R412007360
		G 1/2	G 1/2				Plug ISO 15217, form C	R412007337
		G 1/2	G 1/2				Plug ISO 15217, form C	R412007383
		G 1/2	G 1/2				Socket M12x1	R412007354
		G 1/2	G 1/2				Socket M12x1	R412007356
		G 1/2	G 1/2				Socket M12x1	R412007398
	-	G 3/8	G 3/8	G 1/2	-	-		R412007381
		G 1/2	G 1/2				-	R412007387

Preparation of compressed air ► Maintenance units and components

3/2-directional valve, electrically operated, Series AS3-SOV-...-POS

► With integrated sensor ST6 ► G 3/8 - G 1/2 ► pipe connection

Part No.	Electr. connection	Cable length	Weight	Fig.	Note
	Sensor	Sensor			
		[m]	[kg]		
R412007359	Plug, M8, 3-pin, with knurled screw	0.3	0.459	Fig. 2	1)
R412007336	Plug, M12, 3-pin, with knurled screw	0.3		Fig. 2	
R412007377	without wire end ferrule, tin-plated	3		Fig. 2	
R412007353	Plug, M8, 3-pin, with knurled screw	0.3		Fig. 3	
R412007355	Plug, M12, 3-pin, with knurled screw	0.3		Fig. 3	
R412007396	without wire end ferrule, tin-plated	3		Fig. 3	
R412007360	Plug, M8, 3-pin, with knurled screw	0.3		Fig. 2	
R412007337	Plug, M12, 3-pin, with knurled screw	0.3		Fig. 2	
R412007383	without wire end ferrule, tin-plated	3		Fig. 2	
R412007354	Plug, M8, 3-pin, with knurled screw	0.3		Fig. 3	
R412007356	Plug, M12, 3-pin, with knurled screw	0.3		Fig. 3	
R412007398	without wire end ferrule, tin-plated	3		Fig. 3	
R412007381	without wire end ferrule, tin-plated	3	0.459	Fig. 1	2)

1) Basic valve with pilot valve

2) Basic valve without pilot valve

Electronic sensor included in scope of delivery (assembled).

For sensor connection, see the selection table.

Nominal flow Q_n with secondary pressure $p_2 = 6$ bar at $\Delta p = 1$ bar

MO = Manual override

Flow rate characteristic

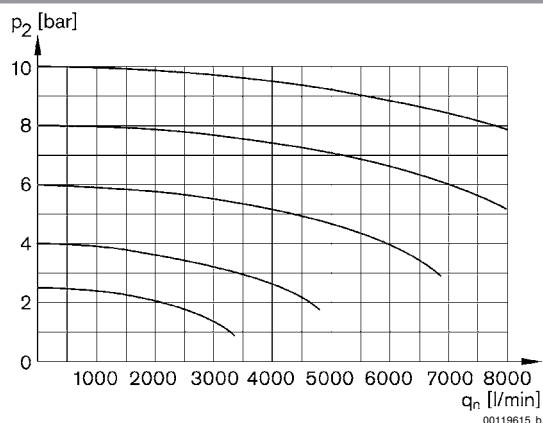

p_2 = secondary pressure
 q_n = nominal flow

Rear exhaust

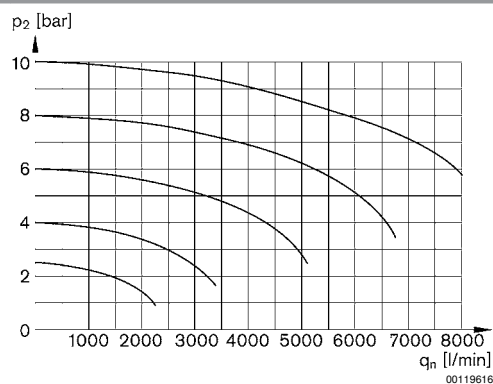

p_2 = secondary pressure
 q_n = nominal flow

3/2-directional valve, electrically operated, Series AS3-SOV-...-POS
▶ With integrated sensor ST6 ▶ G 3/8 - G 1/2 ▶ pipe connection

Fig. 1: 3/2-directional valve without pilot valve with porting configuration for series DO16

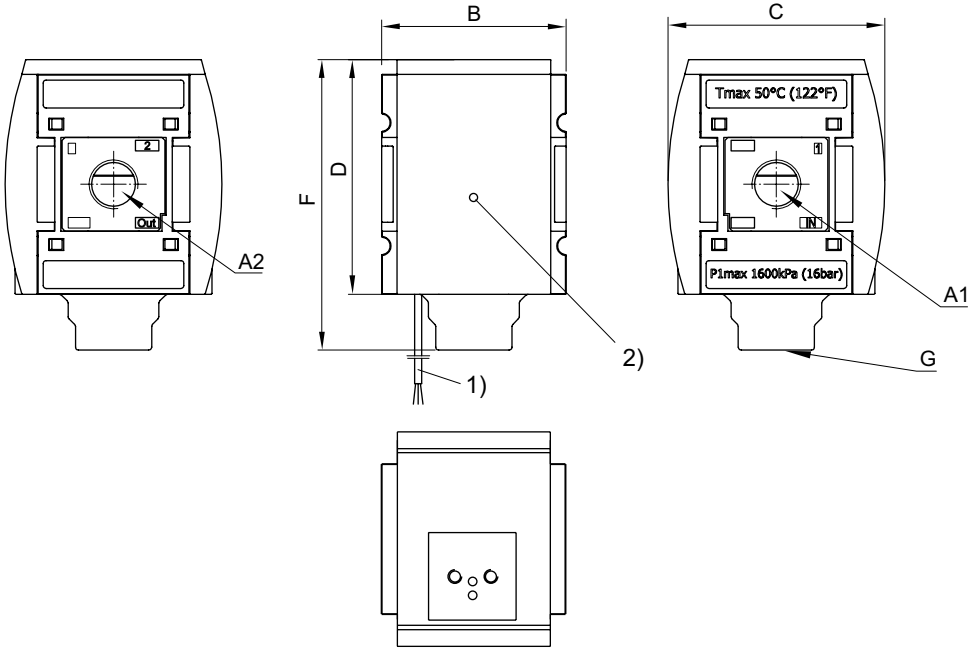

00136397

- A1 = input
A2 = output
1) Connection cable
2) Optical switch status indicator

A1	A2	B	C	D	F	G							
G 3/8	G3/8	63	74	80	99	G1/2							
G 1/2	G1/2	63	74	80	99	G1/2							

3/2-directional valve, electrically operated, Series AS3-SOV-...-POS
► With integrated sensor ST6 ► G 3/8 - G 1/2 ► pipe connection

Fig. 2: 3/2-directional valve with pilot valve and port for electrical connector form C

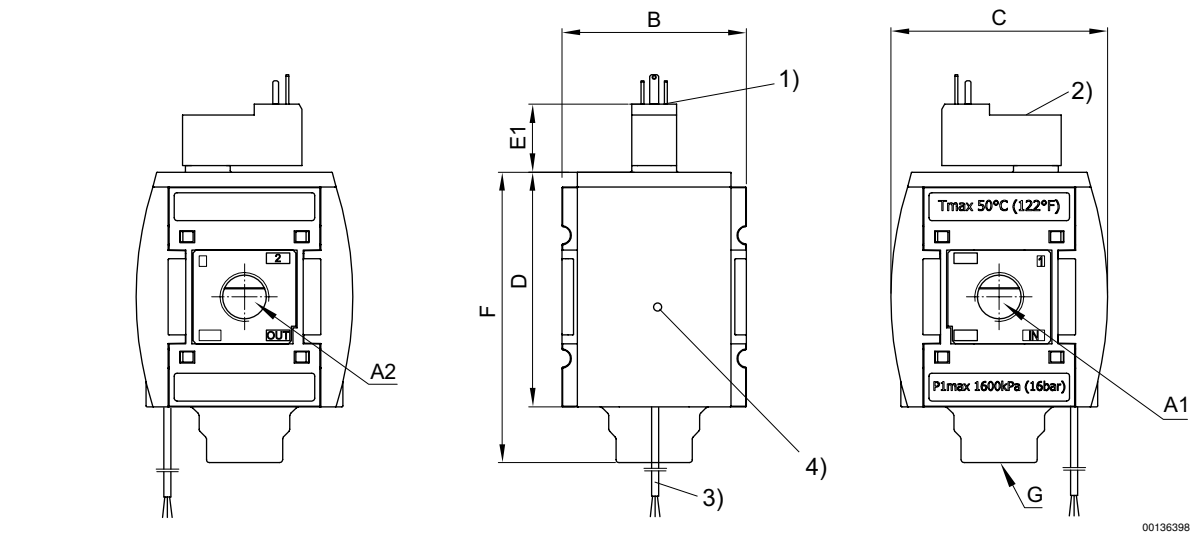

- A1 = input
A2 = output
1) Electr. connection: electrical connector form C, ISO 15217
2) Manual override
3) Connection cable
4) Optical switch status indicator

A1	A2	B	C	D	E1	F	G						
G 3/8	G3/8	63	74	80	23.2	99	G1/2						
G 1/2	G1/2	63	74	80	23.2	99	G1/2						

3/2-directional valve, electrically operated, Series AS3-SOV-...-POS
▶ With integrated sensor ST6 ▶ G 3/8 - G 1/2 ▶ pipe connection

Fig. 3: 3/2-directional valve with pilot valve, push-in fitting M12x1

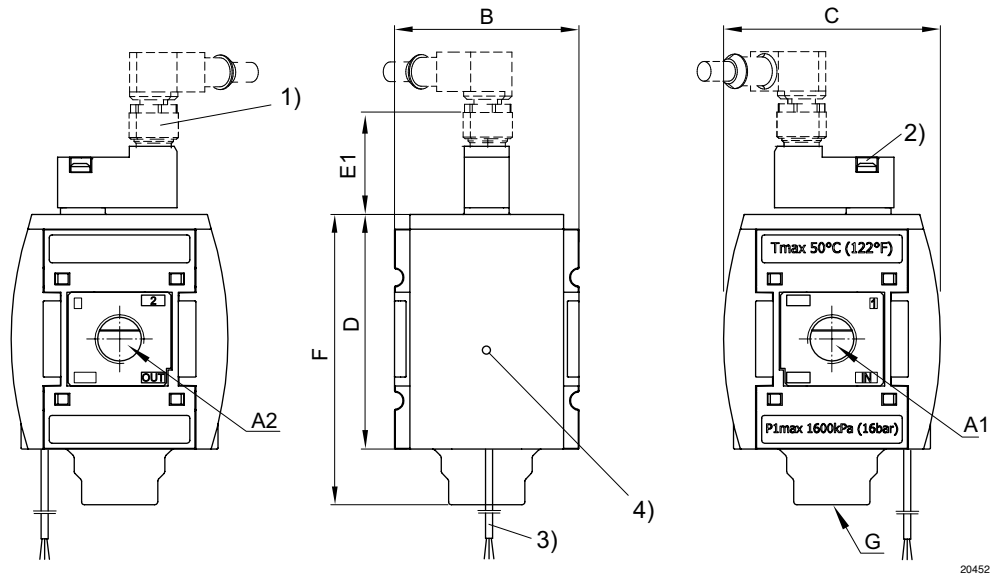

- A1 = input
A2 = output
1) plug M12
2) Manual override
3) Connection cable
4) Optical switch status indicator

A1	A2	B	C	D	E1	F	G						
G 3/8	G3/8	63	74	80	39	99	G1/2						
G 1/2	G1/2	63	74	80	39	99	G1/2						

Pin assignment M12x1

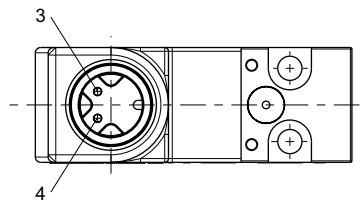

- 3: +/-
4: +/-