

**The Timken Company**

4500 Mt Pleasant St. NW

N. Canton, OH 44720

**Phone:** (234) 262-3000

**E-Mail:** [CustomerCAD@timken.com](mailto:CustomerCAD@timken.com) • **Web site:** [www.timken.com](http://www.timken.com)

## Bearing Unit - Adapter Sleeve UKP213 - H2313, UKP 200 Pillow Block Mounted Bearings - Adapter Sleeve Locking

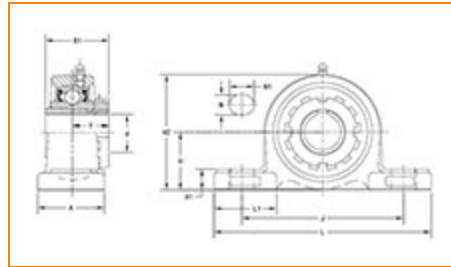

[Specifications](#) | [Dimensions](#) | [Basic Load Ratings](#)

### Specifications

<b>Bearing Unit - Adapter Sleeve</b>	UK213 - H2313
<b>Shaft Size d</b>	60 mm
<b>Adapter Sleeve Number<sup>1</sup></b>	H2313
<b>Locking Style</b>	Adapter Sleeve Locking
<b>Housing Construction</b>	Two-Bolt Pillow Block

### Dimensions

<b>Base to Center Height H</b>	76.2 mm 3 in
<b>Total Length L</b>	265 mm 10.433 in
 <b>Housing Width A</b>	70 mm 2.756 in

<b>Bolt Hole Spacing J</b>	203 mm 7.992 in
<b>Bolt Hole Size N</b>	25 mm 0.984 in
<b>Bolt Hole Length N1</b>	30 mm 1.181 in
<b>Foot Height H1</b>	27 mm
<b>Total Height H2</b>	150 mm 5.906 in
<b>Dimension L1</b>	78 mm 3.071 in
<b>Center of Bearing from End Y</b>	37.5 mm 1.476 in
<b>Dimension B1</b>	65 mm 2.559 in

## Basic Load Ratings

<b>Static Load Rating</b>	40100 N 9015 lbf
<b>Dynamic Load Rating</b>	57200 N 12859 lbf

<sup>1</sup> Purchase the Adapter Sleeve separately

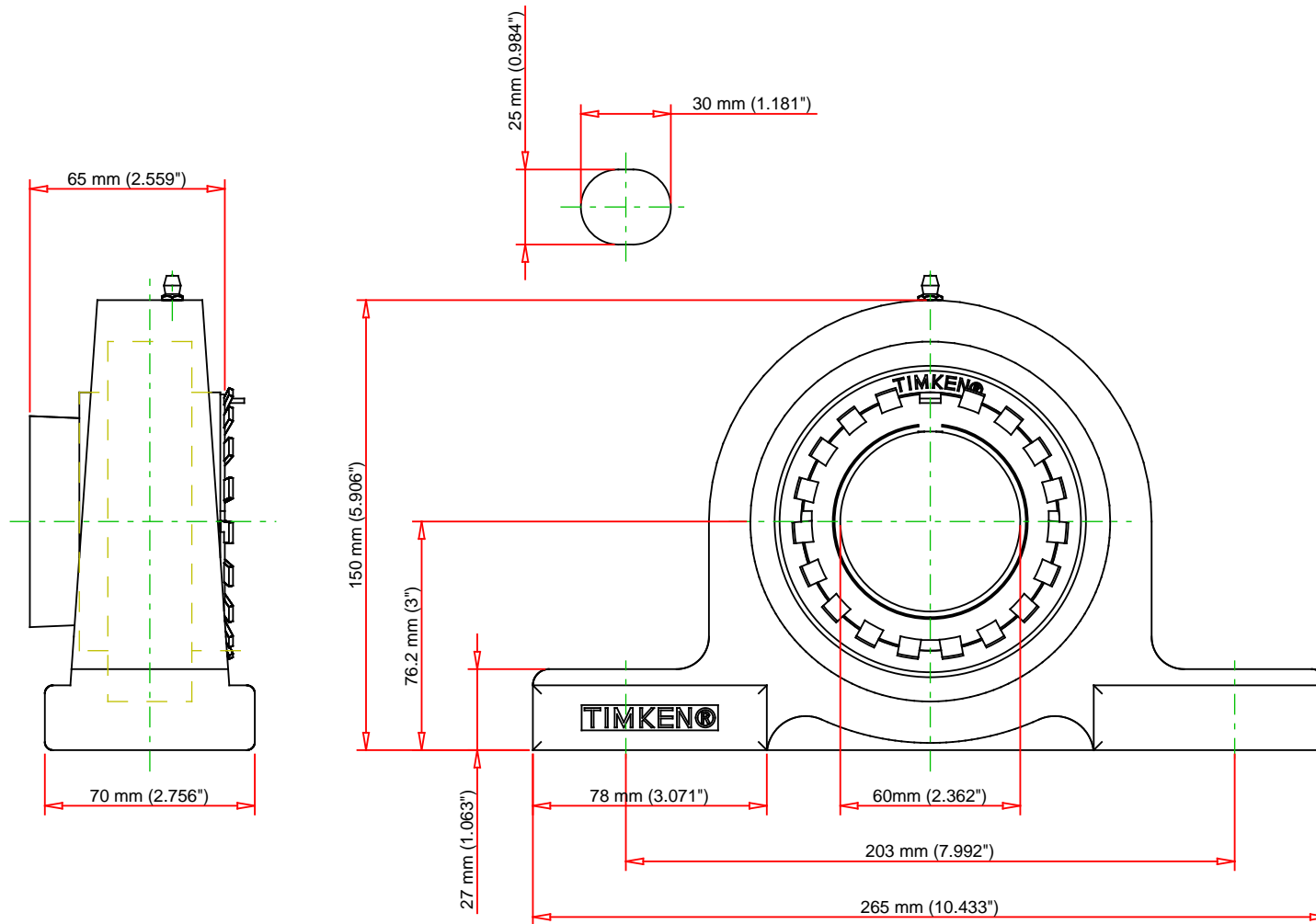

Note: Adapter sold separately

	Bearing Number	UK213 - H2313					<b>UKP213 - H2313</b> UKP 200 Pillow Block Mounted Bearings - Adapter Sleeve Locking
	Load Ratings - C <sub>r</sub>	12859	lbf	57200	N		
	Load Ratings - C <sub>0r</sub>	9015	lbf	40100	N		
	Weight	13.1	lb	5.9	kg		
						THE TIMKEN COMPANY NORTH CANTON, OHIO USA	<b>FOR DISCUSSION ONLY</b>
Every reasonable effort has been made to ensure the accuracy of the information contained in this writing, but no liability is accepted for errors, omissions or for any other reason.							