

The Timken Company

4500 Mt Pleasant St. NW

N. Canton, OH 44720

Phone: (234) 262-3000

E-Mail: CustomerCAD@timken.com • **Web site:** www.timken.com

Bearing Unit - Adapter Sleeve UKP212 - HS2312, UKP 200 Pillow Block Mounted Bearings - Adapter Sleeve Locking

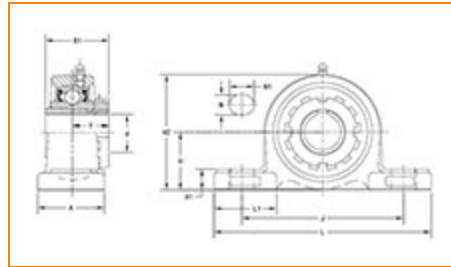

[Specifications](#) | [Dimensions](#) | [Basic Load Ratings](#)

Specifications

Bearing Unit - Adapter Sleeve	UK212 - HS2312
Shaft Size d	2.1250 in
Adapter Sleeve Number¹	HS2312
Locking Style	Adapter Sleeve Locking
Housing Construction	Two-Bolt Pillow Block

Dimensions

Base to Center Height H	69.8 mm 2.748 in
Total Length L	241 mm 9.488 in
 Housing Width A	70 mm 2.756 in

Bolt Hole Spacing J	184 mm 7.244 in
Bolt Hole Size N	20 mm 0.787 in
Bolt Hole Length N1	25 mm 0.984 in
Foot Height H1	25 mm
Total Height H2	138 mm 5.433 in
Dimension L1	72.5 mm 2.854 in
Center of Bearing from End Y	36.5 mm 1.437 in
Dimension B1	62 mm 2.441 in

Basic Load Ratings

Static Load Rating	36200 N 8138 lbf
Dynamic Load Rating	52400 N 11780 lbf

¹ Purchase the Adapter Sleeve separately

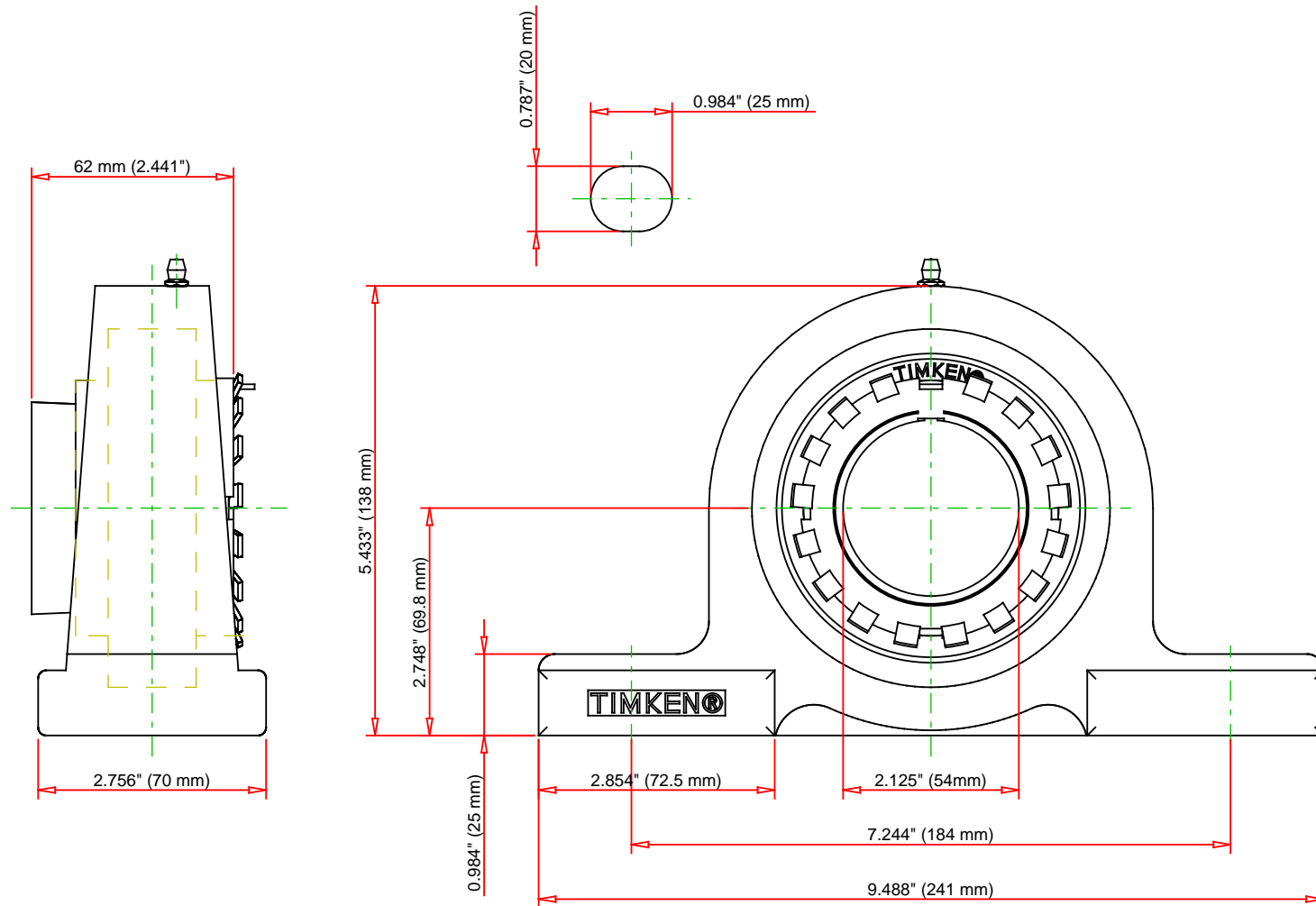

Note: Adapter sold separately

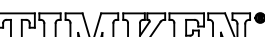
	Bearing Number	UK212 - HS2312					UKP212 - HS2312 UKP 200 Pillow Block Mounted Bearings - Adapter Sleeve Locking
	Load Ratings - C _r	11780	lbf	52400	N		
	Load Ratings - C _{0r}	8138	lbf	36200	N		
	Weight	10.6	lb	4.8	kg		
						THE TIMKEN COMPANY NORTH CANTON, OHIO USA	
Every reasonable effort has been made to ensure the accuracy of the information contained in this writing, but no liability is accepted for errors, omissions or for any other reason.							FOR DISCUSSION ONLY