



The Timken Company

4500 Mt Pleasant St. NW

N. Canton, OH 44720

Phone: (234) 262-3000

E-Mail: CustomerCAD@timken.com • **Web site:** www.timken.com

Part Number UCF324, UCF 300 Four-Bolt Flanged Mounted Bearings - Set Screw Locking

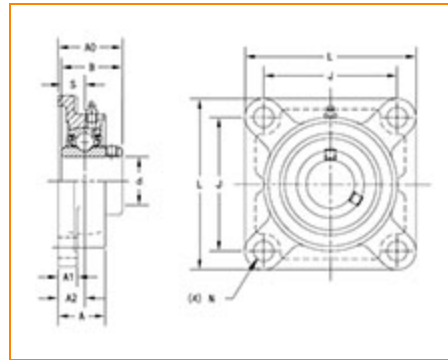

[Specifications](#) | [Dimensions](#) | [Basic Load Ratings](#)

Specifications

Bearing Number	UC324
Shaft Size d	120 mm
Locking Style	Set Screw Locking
Housing Construction	Four-Bolt Square Flange

Dimensions

Total Length L	370 mm 14.567 in
Housing Width A	110 mm 4.331 in
Bolt Hole Spacing J	290 mm 11.417 in



Bolt Hole Size N	41 mm 1.614 in
Flange Thickness A1	40 mm 1.575 in
Center of Bearing from Housing End A2	65 mm 2.559 in
Inner Ring Width B	126 mm 4.961 in
Center of Bearing from Bearing End S	51 mm 2.008 in
Dimension A0	140 mm 5.5 in
Bolt Size	M36
Grease Nipple Size	A-R1/8

Basic Load Ratings

Static Load Rating	185000 N 41590 lbf
Dynamic Load Rating	207000 N 46536 lbf

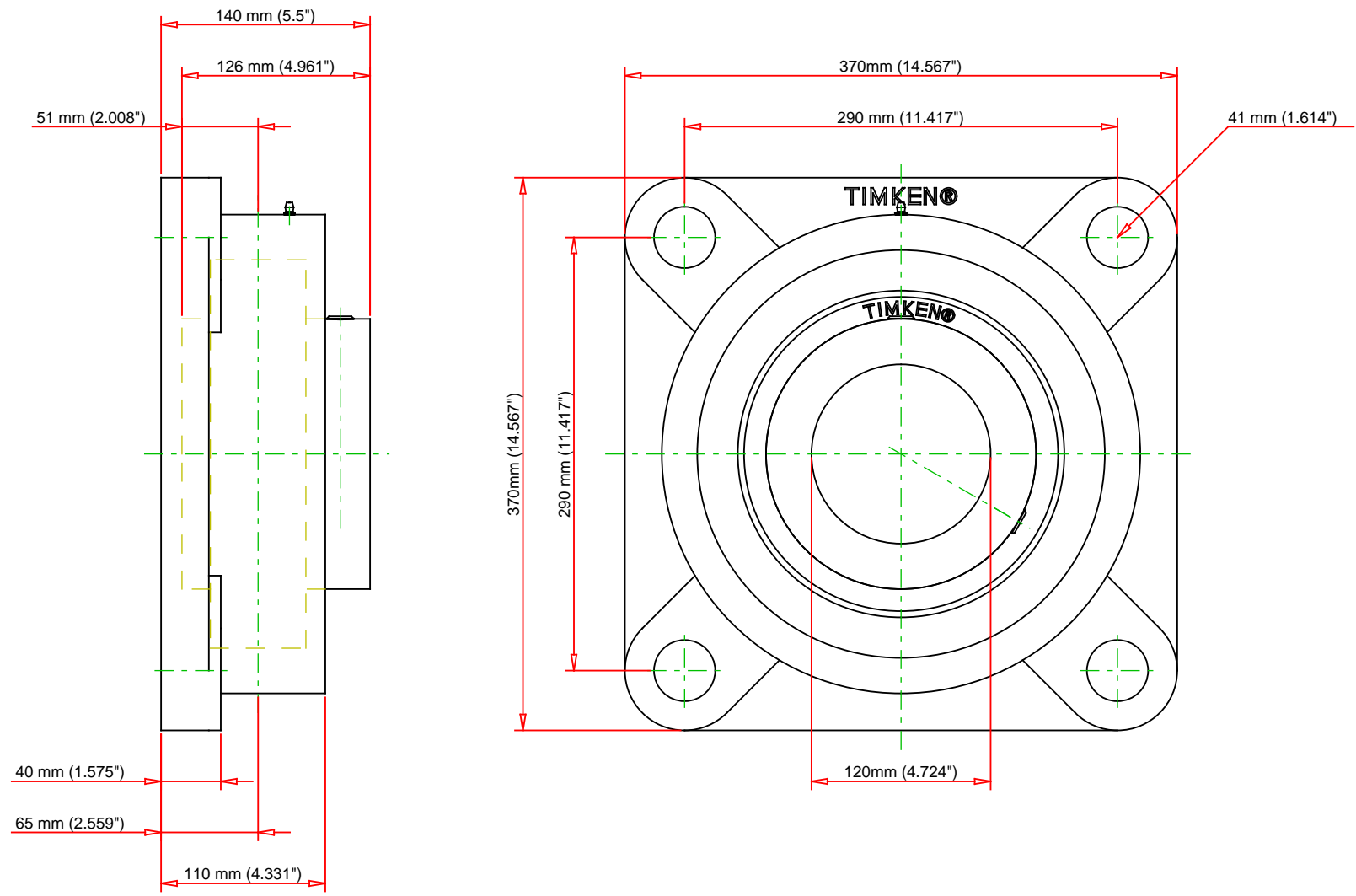

	Bearing Number	UC324					UCF324 UCF 300 Four-Bolt Flanged Mounted Bearings - Set Screw Locking
	Load Ratings - C _r	46536	lbf	207000	N		
	Load Ratings - C _{0r}	41590	lbf	185000	N		
	Weight	104.3	lb	47.3	kg		
	Bolt Size	M36					
Every reasonable effort has been made to ensure the accuracy of the information contained in this writing, but no liability is accepted for errors, omissions or for any other reason.							FOR DISCUSSION ONLY