

# LOE Lubricators – D Series, NPT

Technical Data

FESTO

Function

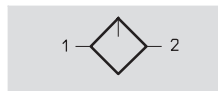

Flow rate

160 ... 9000 l/min

Temperature range

-10 ... +60 °C

Pressure

1 ... 16 bar

The proportional lubricator adds a precision adjustable quantity of oil to the compressed air stream.

The pressure drop that occurs when air flows through a Venturi nozzle is used to convey oil from the container to the drip cap. From here, the oil drips into the air duct directly behind the proportional valve, where it is atomised. The oil mist component is proportional to the compressed air flow rate.



- Proportional lubricator with precision oil metering
- Reduces wear on drive units subject to high loading
- High flow rate
- Quick and easy oil top-up
- Robust metal housing
- Transparent lubricator bowl with metallic bowl guard

The following oils are recommended for Festo components:

Viscosity range to  
ISO 3448, ISO class VG 32  
32 mm<sup>2</sup>/s (= cSt) at 40 °C

- Festo special oil → page 9
- ARAL Vitam GF 32
- BP Energol HLP 32
- Esso Nuto H 32
- Mobil DTE 24
- Shell Tellus Oil DO 32

General technical data									
Size	Micro	Mini			Midi			Maxi	
Pneumatic connection	1/8 NPT	1/8 NPT	1/4 NPT	3/8 NPT	3/8 NPT	1/2 NPT	3/4 NPT	3/4 NPT	1 NPT
Operating medium	Filtered compressed air, unlubricated								
Grade of filtration [µm]	5	40							
Design	Proportional standard mist lubricator								
Type of mounting	Via accessories								
	In-line installation								
Assembly position	Vertical ±5°								
Input pressure [bar]	0 ... 10	0 ... 16							
Minimum flow for lubricator operation [l/min]	3				8			10	
Maximum oil capacity [cm³]	6.5	45			110			190	

Note: This product conforms to ISO 1179-1 and ISO 228-1

Standard nominal flow rate <sup>1)</sup> qnN [l/min]			
Connection	Port block		
	1/8NPT	QS4	QS6
Micro			
LOE	410	160	330

1) Measured at p1 = 6 bar and Δp = 1 bar.

# LOE Lubricators – D Series, NPT

Technical Data – Dimensional Drawings

**FESTO**

## Dimensions

Download CAD Data → [www.festo.com/us/cad](http://www.festo.com/us/cad)

### Mini/Midi/Maxi

With threaded port blocks

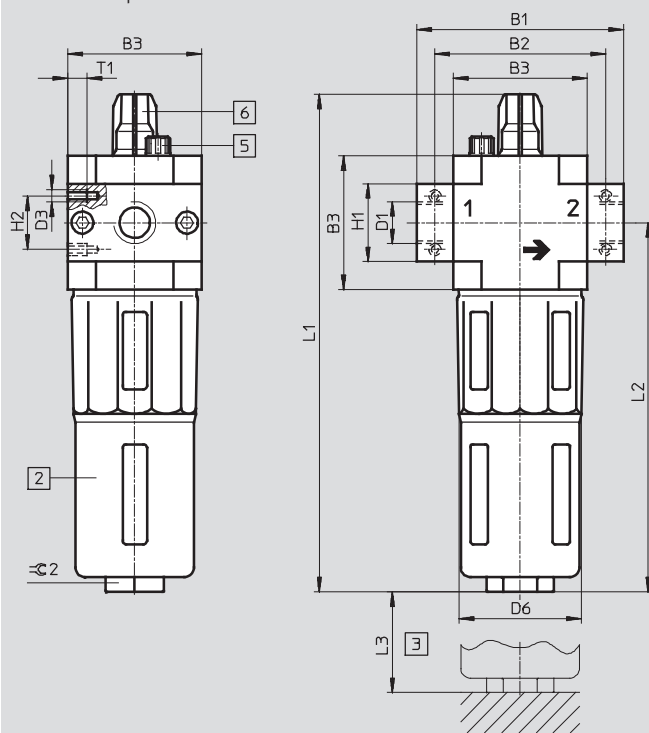

Without threaded port blocks

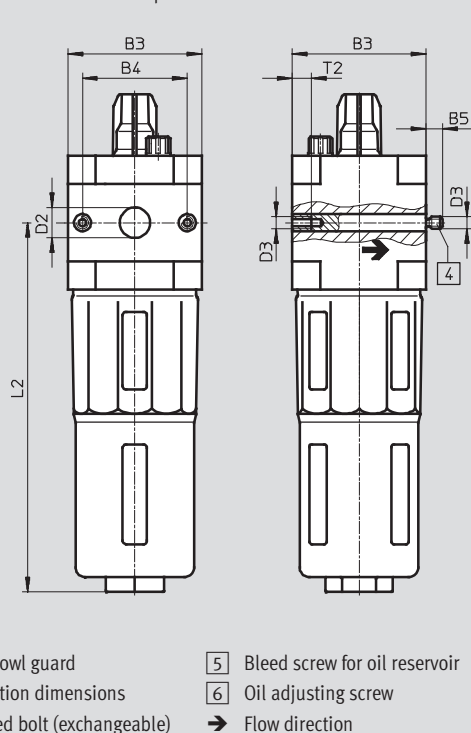

- 2 Metal bowl guard
- 3 Installation dimensions
- 4 Threaded bolt (exchangeable)
- 5 Bleed screw for oil reservoir
- 6 Oil adjusting screw
- Flow direction

Type	B1	B2	B3	B4	B5	D1	D2 Ø	D3	D6 Ø	H1	H2	L1	L2	L3	T1	T2	≈ 2
Mini																	
LOE-1/8-D-MINI	64	52	40	30	–	1/8 NPT	–	M4	38	20	11	169	124	100	7	–	22
LOE-1/4-D-MINI						1/4 NPT											
LOE-3/8-D-MINI	70					3/8 NPT											
LOE-D-MINI	–	–			5.8	–	11			–	–				–	10	
Midi																	
LOE-3/8-D-MIDI	85	70	55	43	–	3/8 NPT	–	M5	52	32	22	204	151	120	8	–	24
LOE-1/2-D-MIDI						1/2NPT											
LOE-3/4-D-MIDI						3/4 NPT											
LOE-D-MIDI	–	–			6.8	–	24			–	–				–	11	
Maxi																	
LOE-3/4-D-MAXI	96	80	66	46	–	3/4 NPT	–	M5	65	32	22	228	170	150	8	–	24
LOE-1-D-MAXI	116	91				1 NPT				40							
LOE-D-MAXI	–	–				6.8				–	30						

Note: This product conforms to ISO 1179-1 and ISO 228-1