

New Range of Threaded Elbows

> **Transair threads** are well recognized for their robustness and reliability, enabling connection to an existing network and many types of machinery.

Transair threaded elbows save time during installation and replace the need for three separate components saving space in restricted work areas.

• The wide range of Transair threaded elbows meets the requirements of each installation:

- **Several thread sizes** are available for each pipe diameter
- 90° and 45° elbows reduce pressure drops
- A compact solution allowing connection in reduced spaces
- **Orientable sub-base** allowing final positioning after installation
- Brass sub-base ensuring a **rigid and reliable connection**

6609

Male threaded 90° elbow - BSP taper

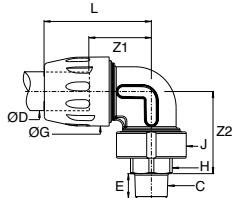

ØD	C	Transair®	E	H	ØG	ØJ	L	Z1	Z2	kg
16,5	R1/4	6609 17 13	9,5	17	34,0	34,0	58,0	31,0	41,2	0,104
16,5	R1/2	6609 17 21	15,0	23	34,0	34,0	58,0	31,0	46,5	0,133
25	R1/2	6609 25 21	15,0	27	44,5	45,5	69,5	40,5	53,0	0,223
25	R3/4	6609 25 27	15,0	27	44,5	45,5	69,5	40,5	53,0	0,238
25	R1"	6609 25 34	16,0	36	44,5	45,5	69,5	40,5	55,0	0,295
40	R1"	6609 40 34	16,0	41	67,0	68,5	107,0	62,0	75,0	0,646
40	R1"1/4	6609 40 42	21,5	50	67,0	68,5	107,0	62,0	81,0	0,792
40	R1"1/2	6609 40 49	24,5	50	67,0	68,5	107,0	62,0	81,0	0,754
40	R2"	6609 40 48	23,0	60	67,0	68,5	107,0	62,0	81,0	0,869
63	R2"	6609 63 48	20,0	70	91,0	91,0	124,0	61,0	104,0	1,452
63	R2"1/2	6609 63 47	25,0	80	91,0	91,0	124,0	61,0	106,0	1,831

6619

Male threaded 45° elbow - BSP taper

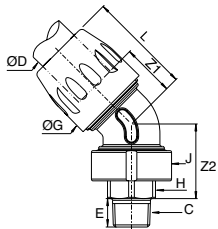

ØD	C	Transair®	E	H	ØG	ØJ	L	Z1	Z2	kg
25	R1/2	6619 25 21	15,0	27	44,5	45,5	61,5	32,5	42,0	0,217
25	R3/4	6619 25 27	15,0	27	44,5	45,5	61,5	32,5	42,0	0,228
25	R1"	6619 25 34	16,0	36	44,5	45,5	61,5	32,5	44,0	0,285
40	R1"	6619 40 34	16,0	41	67,0	68,5	94,0	45,0	58,5	0,609
40	R1"1/4	6619 40 42	21,5	50	67,0	68,5	94,0	45,0	64,0	0,754
40	R1"1/2	6619 40 49	24,5	50	67,0	68,5	94,0	45,0	64,0	0,717
40	R2"	6619 40 48	23,0	60	67,0	68,5	94,0	45,0	64,0	0,832

New 63mm 45° Elbow

> 45° elbows are increasingly used to reduce pressure drops when changing level or when creating a bypass. Transair now offers a 63mm version in cast aluminium, with the same robust design as the 90° version.

6612

45° elbow

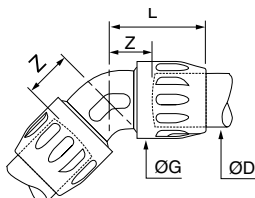

ØD	Transair®	ØG	L	Z	kg
63	6612 63 00	91,0	100,0	61,0	0,920