

Product Data Sheet



Product Code: **EM/STOP**

Issue No.

Issue Date:

Issue by:

A

01/ 08 /2016

T.T.

Description:

Emergency Stop push button, "twist to release" reset operation. Fitted with 1 x normally closed contact.

General Characteristics

| | |
|-------------------------------------|---|
| Standards. | EN60947-4-1. EN60947-5-1. |
| Contact | EN60947-5-5. |
| Contact rating. | AC15 : 10A 250V, 8A 400V. AC1 : 16A 250V DC13 : 2A 24V DC |
| Ui | 690Vac |
| U imp | 4 kV |
| Protection. | Maximum backup fuse – 16A. 1 kA. |
| Enclosure. | Nylon 66 with 10% glass fibre fill. PA66-GF10. |
| IP Rating. | IP 65 (indoor use only). |
| Pollution degree. | 3 |
| No of poles. | 1 |
| Contact terminal capacity. | 2 x 2.5mm.sq. |
| Contact terminal tightening torque. | 0.8 Nm |
| Cable entry facility. | 1 x M16 KO top. 1 x M20 KO bottom. 1 x M16 KO rear. |
| Operating head | Red, 40mm diameter. Direction arrow moulded in head. Direct drive on contacts. |
| Maximum number of contacts | 3 – any combination of normally open or closed. |
| Equipment type. | Fixed stationary |
| Weight. | 150g |

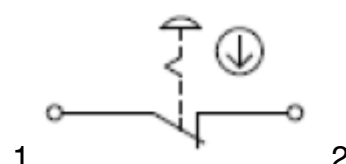

Normally closed

Switchgear Fitted

| Device | Rating |
|------------------------------|-----------|
| 1 x Normally closed contact. | See above |

Additional contacts can be ordered separately.
Part no. EMCB1NO – normally open.
Part no. EMCB1NC – normally closed.

Product Data Sheet



Product Code: **EM/STOP**

Issue No.

Issue Date:

Issue by:

A

01 /08 /2016

T.T.

Description

Key Dimensions

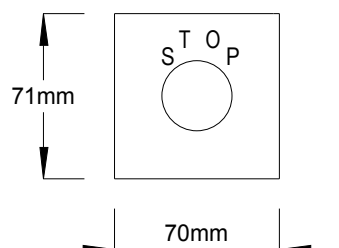

Depth : 90mm over push button

Mounting hole positions

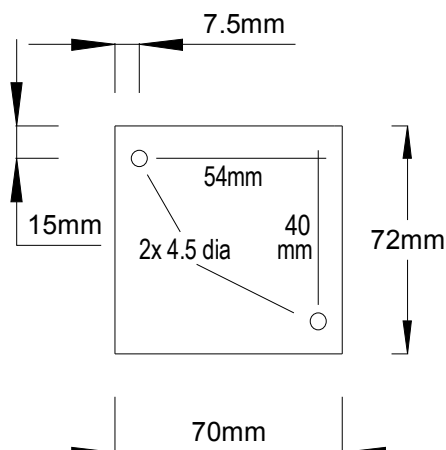

Additional information.

Usage :

Emergency Stop by normal persons. Reset Intended for use by skilled persons or instructed persons.

Electrical

Earth & Neutral terminals - None

Rated frequency: 50Hz.

Rated operational voltage: Various – see contact rating.

Rated insulation voltage: 690V

Earthing system: Not Applicable.

EMC environment: Environment type A.

Physical

Ambient operating temperature -5 to 40 °C. Humidity ≤ 50% @ 40C, 90% @ 20C. If excessive condensation preventative measures are to be taken (Not exceeding average of 35 °C in any 24 hour period).

Maximum altitude 2000m.

Wiring : When wiring in to a circuit appropriate measures should be taken to ensure an unintended re-energisation of the load cannot occur when the Emergency Stop button is reset. i.e. maintaining contact on a contactor.

Installation

Service conditions: Wiring of this product must comply with current IEE regulations. Units are intended for indoor use and dry conditions and **NOT** where high levels of humidity and temperature are experienced.

Note: IP rating of enclosures can be compromised if correct use of glands is not followed when installing unit. Indoor use only.