



**The Timken Company**

4500 Mt Pleasant St. NW

N. Canton, OH 44720

**Phone:** (234) 262-3000

**E-Mail:** [CustomerCAD@timken.com](mailto:CustomerCAD@timken.com) • **Web site:** [www.timken.com](http://www.timken.com)

## Bearing Unit - Adapter Sleeve UKFL218 - H2318, UKFL 200 Two-Bolt Flanged Mounted Bearings- Adapter Sleeve Locking

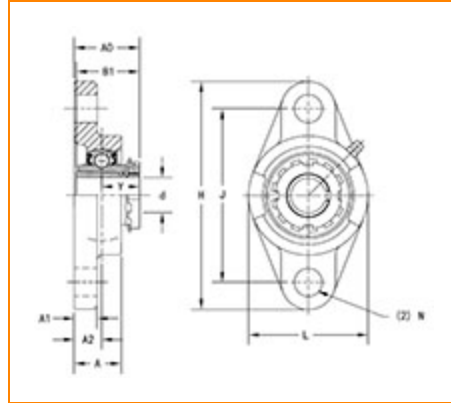

[Specifications](#) | [Dimensions](#) | [Basic Load Ratings](#)

### Specifications

<b>Bearing Unit - Adapter Sleeve</b>	UK218 - H2318
<b>Shaft Size d</b>	80 mm
<b>Adapter Sleeve Number<sup>1</sup></b>	H2318
<b>Locking Style</b>	Adapter Sleeve Locking
<b>Housing Construction</b>	Two-Bolt Flange

### Dimensions

<b>Total Length H</b>	320 mm
<b>Total Height L</b>	205 mm
<b>Housing Width A</b>	68 mm



<b>Bolt Hole Spacing J</b>	265 mm
<b>Bolt Hole Size N</b>	25 mm
<b>Flange Thickness A1</b>	23 mm
<b>Center of Bearing from Housing End A2</b>	40 mm
<b>Center of Bearing from Bearing End Y</b>	49.5 mm
<b>Dimension B1</b>	86 mm
<b>Dimension A0</b>	89.5 mm
<b>Bolt Size</b>	M22

#### Basic Load Ratings

<b>Static Load Rating</b>	71500 N
<b>Dynamic Load Rating</b>	96100 N

<sup>1</sup> Purchase the Adapter Sleeve separately

