



The Timken Company

4500 Mt Pleasant St. NW

N. Canton, OH 44720

Phone: (234) 262-3000

E-Mail: CustomerCAD@timken.com • **Web site:** www.timken.com

Bearing Unit - Adapter Sleeve UKFL217 - H2317, UKFL 200 Two-Bolt Flanged Mounted Bearings- Adapter Sleeve Locking

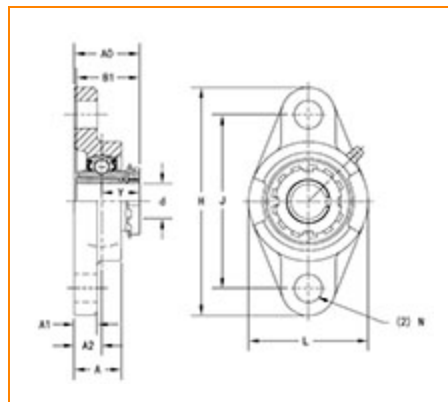

[Specifications](#) | [Dimensions](#) | [Basic Load Ratings](#)

Specifications

Bearing Unit - Adapter Sleeve	UK217 - H2317
Shaft Size d	75 mm
Adapter Sleeve Number¹	H2317
Locking Style	Adapter Sleeve Locking
Housing Construction	Two-Bolt Flange

Dimensions

Total Length H	305 mm 12 in
Total Height L	190 mm 7.469 in



Housing Width A	63 mm 2.48 in
Bolt Hole Spacing J	248 mm 9.764 in
Bolt Hole Size N	25 mm 0.984 in
Flange Thickness A1	22 mm 0.866 in
Center of Bearing from Housing End A2	36 mm 1.417 in
Center of Bearing from Bearing End Y	46.5 mm 1.831 in
Dimension B1	82 mm 3.228 in
Dimension A0	82.5 mm 3.25 in
Bolt Size	M22

Basic Load Ratings

Static Load Rating	61900 N 13916 lbf
Dynamic Load Rating	84000 N 18884 lbf

¹ Purchase the Adapter Sleeve separately

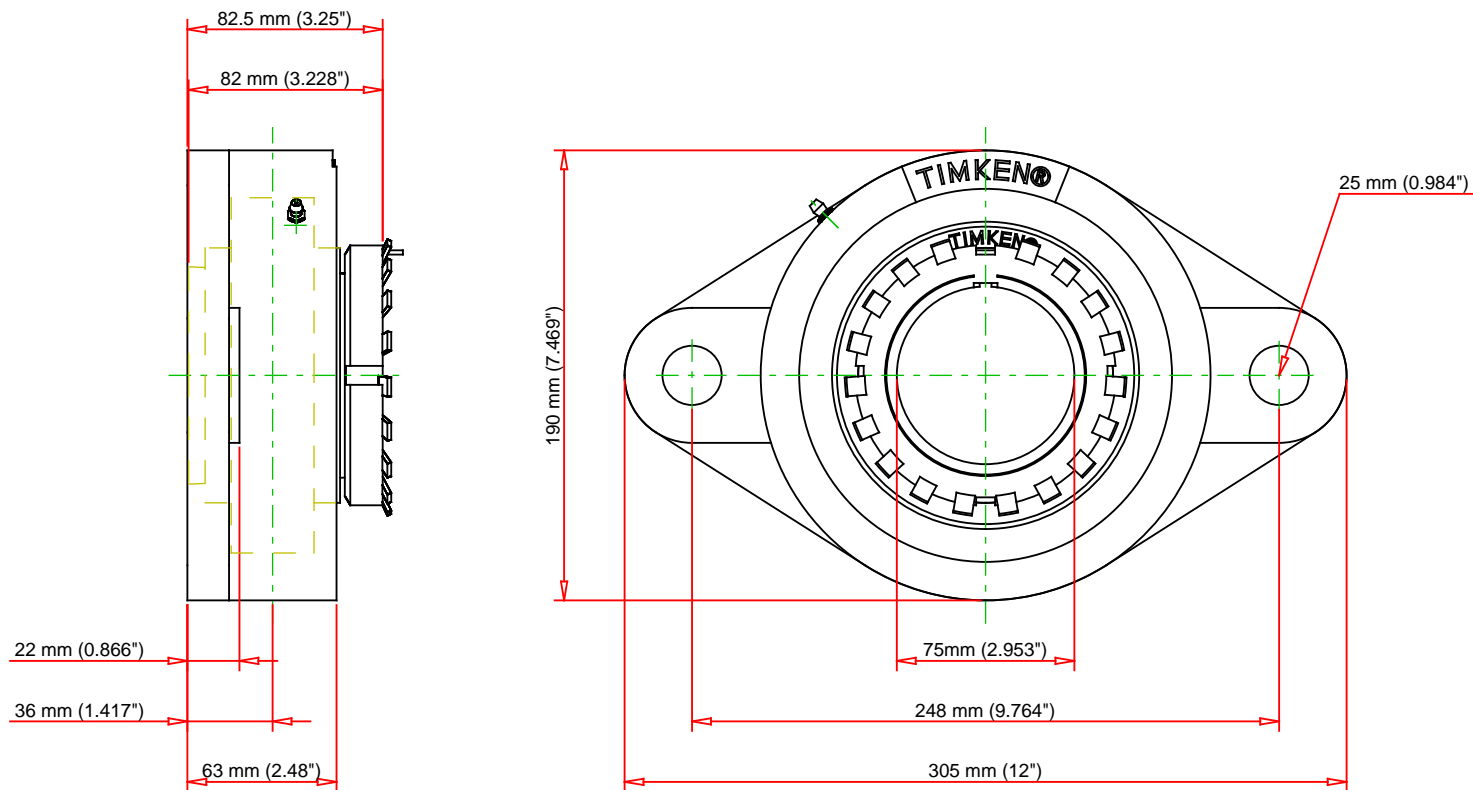

Note: Adapter sold separately

Bearing Number	UK217 - H2317			
Load Ratings - C _r	18884	lbf	84000	N
Load Ratings - C _{0r}	13916	lbf	61900	N
Weight	21.8	lb	9.9	kg

TIMKEN

THE TIMKEN COMPANY
NORTH CANTON, OHIO USA

UKFL217 - H2317
UKFL 200 Two-Bolt Flanged Mounted
Bearings- Adapter Sleeve Locking

Every reasonable effort has been made to ensure the accuracy of the information contained in this writing, but no liability is accepted for errors, omissions or for any other reason.

FOR DISCUSSION ONLY