

# Hydraulic tools



For easy pressure hose connection

## SKF Quick Connecting Coupling and Nipples

One coupling and two different nipples are available to connect SKF Hydraulic Pumps to the work piece. When nipples with other thread types are required, select an additional SKF nipple from the range to make the connection. SKF Nipple 729832 A is supplied standard with all SKF Hydraulic Nuts HMV ..E series.

### Technical data

Designation	Thread	Dimensions	Maximum pressure		
Coupling	d <sub>2</sub>	D <sub>2</sub>	C	A	
729831 A	G <sup>1</sup> / <sub>4</sub>	24 mm (0.94 in.)	27 mm (1.06 in.)	58 mm (2.28 in.)	150 MPa (21 750 psi)

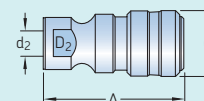

Nipples	d <sub>1</sub>	D <sub>1</sub>	B	A	
729832 A	G <sup>1</sup> / <sub>4</sub>	22 mm (0.87 in.)	14 mm (0.55 in.)	46 mm (1.81 in.)	150 MPa (21 750 psi)
729100	G <sup>1</sup> / <sub>8</sub>	17 mm (0.67 in.)	14 mm (0.55 in.)	43 mm (1.69 in.)	100 MPa (14 500 psi)

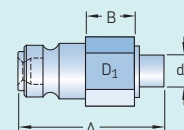

Up to 400 MPa (58 000 psi)

## Plugs for oil ducts and vent holes

SKF plugs have been designed to seal off oil connections at a maximum pressure of 400 MPa (58 000 psi).

### Technical data

Designation	Thread	Length
233950 E	G <sup>1</sup> / <sub>4</sub>	15 mm (0.59 in.)
729944 E	G <sup>1</sup> / <sub>2</sub>	17 mm (0.67 in.)
1030816 E	G <sup>3</sup> / <sub>4</sub>	23 mm (0.90 in.)

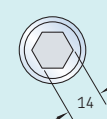
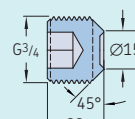
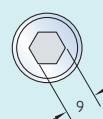
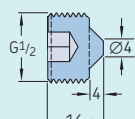
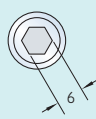
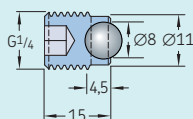

Maximum working pressure 400 MPa (58 000 psi)

Plug 233950 E

Plug 729944 E

Plug 1030816 E