



PCJ17-XL

Flanged housing unit

Schaeffler ID:
0009481010000

Housing units PCJ, four-bolt flanged housing units, cast iron, eccentric locking collar, P seals

X-life

Technical information

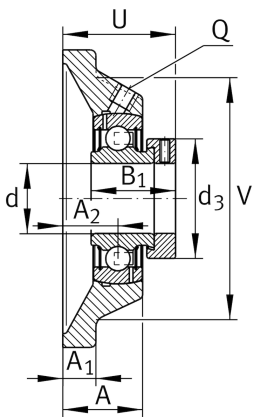
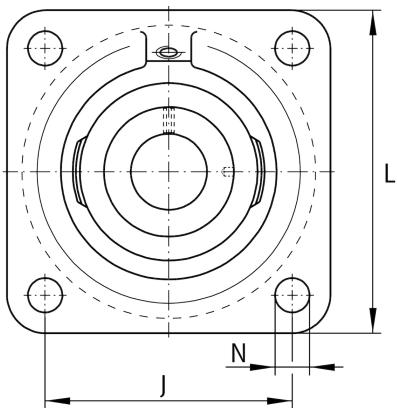

Main Dimensions & Performance Data

d	17 mm	Bore diameter
L	76 mm	Flange width
U	39.1 mm	Total height unit
C _r	10,100 N	Basic dynamic load rating, radial
C _{0r}	4,750 N	Basic static load rating, radial
C _{ur}	248 N	Fatigue load limit, radial
	0.45 kg	Weight

Dimensions

A	27 mm	Height housing
A ₁	9.5 mm	Thickness of flange
A ₂	17 mm	Distance raceway
V	58 mm	Shoulder diameter housing
Q	M6	Connection thread lubrication
d ₃	28.4 mm	Outside diameter eccentric locking collar

Mounting dimensions

J	54 mm	Distance fixing bore
N	11.5 mm	Fixing bore
n	4	Number of screwing holes

Additional information

1	Number of housings
CJ03	Housing
GRAE17-XL-NPP-B	Bearing designation