

## Series TM Multiple Tubing Holder

Can be separated at any position depending on the number of tubes.  
Manufactured from flame resistant resin (Equivalent to UL-94 Standards V-0).

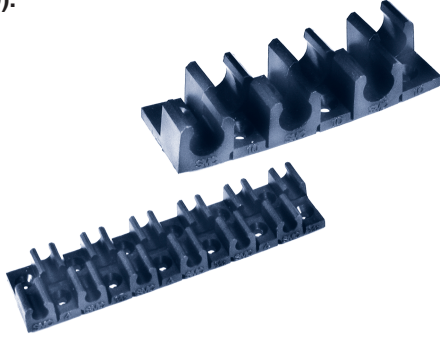

Applicable Tubing O.D.	Model	Number of tubing (MAX.)			Accessory: Phillips countersunk tapping screw	
		6	8	12	Size: Nominal size X length	Number of pieces
4	TM-04			●	2 X 6	4
6	TM-06			●	2.6 X 8	
8	TM-08		●			
10	TM-10	●			3 X 8	
12	TM-12	●				

### How To Use

#### ⚠ Caution

1. The multiple tubing holder can be cut apart according to the number of tubes to be connected.

**CUTTING METHOD**  
Align the cutter with the cutting groove and cut the holder.



2. Cut the multiple tubing holder at a desired position and mount it on the equipment with the attached phillips countersunk tapping screws.
3. Align the tube with the holding position and push down to fit into the holding part.
4. Pull tubing up to remove it from the holder.

## Series TG Tube Releasing

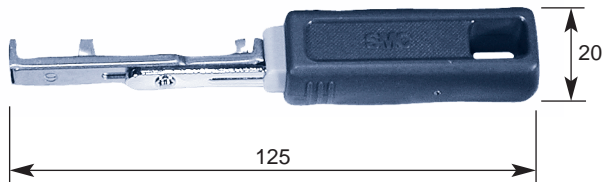

Part No.	Applicable Tube Size		Applicable Tube Material	Color	Weight
TG-1	Metric size	ø4, ø6	Nylon, Soft Nylon	Blue	33g
TG-2	Inch size	ø1/8", ø1/4"	Polyurethane	Red	

- ▲ Aids in the connection and removal of tubing in applications where One-touch™ fittings are located close together, such as on a valve manifold.
- ▲ Easy one handed operation.
- ▲ Available for two sizes of applicable tubes. Easy exchange with one touch.

### How To Use

#### ⚠ Caution

##### Process

Put the end of tool into the release bushing parallel to the tube.

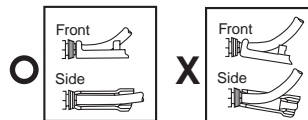
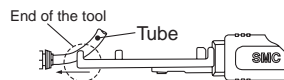

After inserting, grasp the handle tightly and insert the end of the tube to the stroke end.

Note) Insert firmly to guard against accidental tube release.

##### Size Change

Push both sides at once to release. Reversed and fixed at the same position as before. Applicable tube size is indicated on the back side.

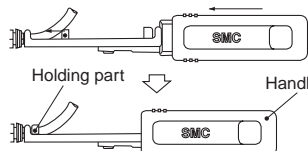
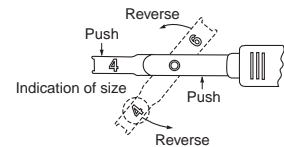

After inserting end of tube, relax your grip on the tool. Returning force of spring releases the tube.