



**The Timken Company**

4500 Mt Pleasant St. NW

N. Canton, OH 44720

Phone: (234) 262-3000

E-Mail: [CustomerCAD@timken.com](mailto:CustomerCAD@timken.com) • Web site: [www.timken.com](http://www.timken.com)

## Part Number GYA100RRB, Fafnir® Wide Inner Ring Setscrew Locking Ball Bearings

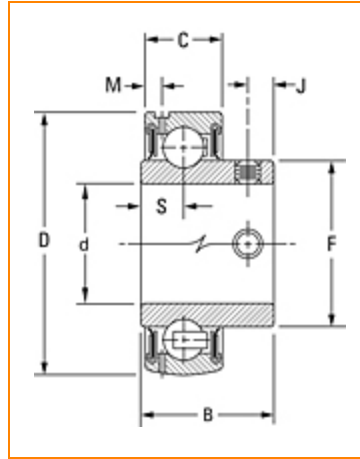

[Specifications](#) | [Dimensions](#) | [Basic Load Ratings](#)

### Specifications

Shaft Size d	1 in 25.4 mm
Bore Type	Cylindrical bore
Bearing Type	Ball Bearing
Material	Bearing Steel
Lubrication Type	Relubricatable
O.D. Type	Spherical OD
Dimension M	0.142 in 3.61 mm
Series	Standard
Weight	0.50 lb 0.2 Kg

<b>Sub Series</b>	GYA..RRB
<b>Seal Type</b>	Narrow Shroud

## Dimensions

<b>Outside Diameter D</b>	2.047 in 52.000 mm
<b>Inner Ring Width B</b>	28.2 mm 1.110 in
<b>Outside Ring Width C</b>	15.000 mm 0.591 in
<b>Radius r</b>	0.6 mm 0.024 in
<b>Center of Bearing from End S</b>	8.84 mm 0.348 in
<b>Dimension S1</b>	19.36 mm 0.762 in
<b>Set Screw Distance S2</b>	6.35 mm 0.250 in
<b>Set Screw Size</b>	M6x1
<b>Number of Set Screws</b>	2
<b>Angle between Set Screws</b>	90 °

## Basic Load Ratings

<b>Static Load Rating</b>	1750 lbf 7800 N
<b>Dynamic Load Rating</b>	3490 lbf 15500 N

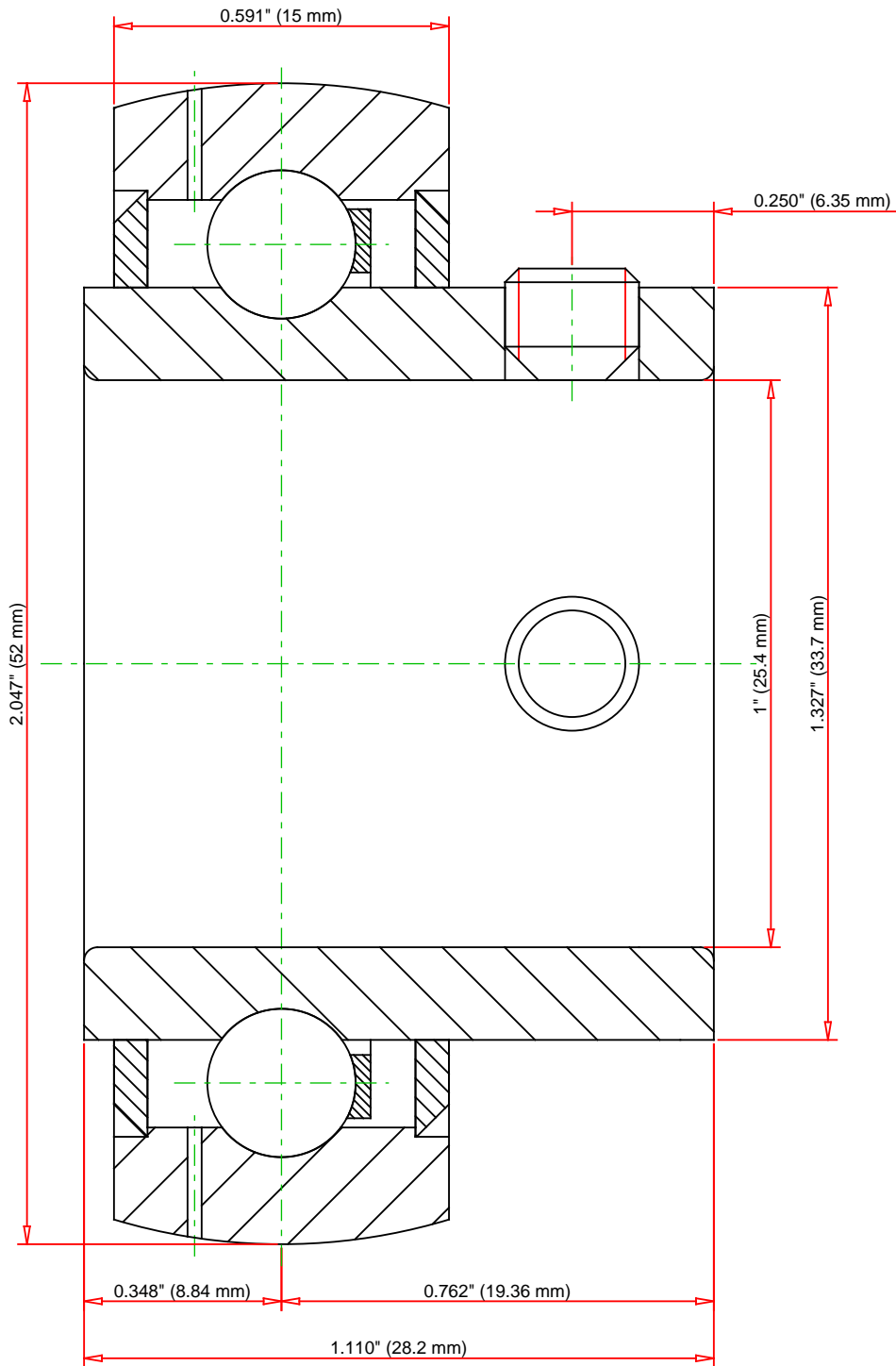

Weight	0.5 lb	0.2 kg	<div>TIMKEN®</div> <div>THE TIMKEN COMPANY</div> <div>NORTH CANTON, OHIO USA</div>	<div>GYA100RRB</div> <div>Fafnir® Wide Inner Ring Setscrew Locking Ball Bearings</div>		
				Basic Load Ratings - C <sub>r</sub>		
				Load Ratings - C <sub>0r</sub>		
Every reasonable effort has been made to ensure the accuracy of the information contained in this writing, but no liability is accepted for errors, omissions or for any other reason.				FOR DISCUSSION ONLY		