



**The Timken Company**

4500 Mt Pleasant St. NW

N. Canton, OH 44720

**Phone:** (234) 262-3000

**E-Mail:** [CustomerCAD@timken.com](mailto:CustomerCAD@timken.com) • **Web site:** [www.timken.com](http://www.timken.com)

## Bearing Unit - Adapter Sleeve UKFL215 - HE2315, UKFL 200 Two-Bolt Flanged Mounted Bearings- Adapter Sleeve Locking

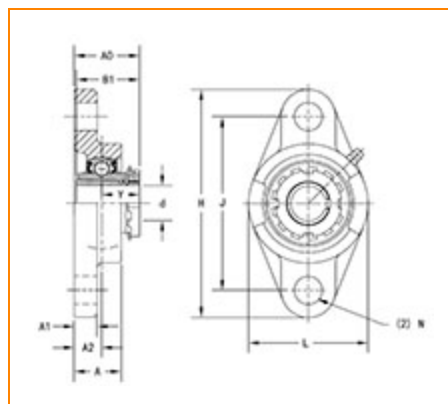

[Specifications](#) | [Dimensions](#) | [Basic Load Ratings](#)

### Specifications

<b>Bearing Unit - Adapter Sleeve</b>	UK215 - HE2315
<b>Adapter Sleeve Number<sup>1</sup></b>	HE2315
<b>Locking Style</b>	Adapter Sleeve Locking
<b>Housing Construction</b>	Two-Bolt Flange

### Dimensions

<b>Total Length H</b>	275 mm
<b>Total Height L</b>	165 mm
<b>Housing Width A</b>	56 mm
<b>Bolt Hole Spacing J</b>	225 mm



<b>Bolt Hole Size N</b>	23 mm
<b>Flange Thickness A1</b>	20 mm
<b>Center of Bearing from Housing End A2</b>	34 mm
<b>Center of Bearing from Bearing End Y</b>	40.5 mm
<b>Dimension B1</b>	73 mm
<b>Dimension A0</b>	74.5 mm
<b>Bolt Size</b>	M20

#### Basic Load Ratings

<b>Static Load Rating</b>	48300 N
<b>Dynamic Load Rating</b>	67400 N

<sup>1</sup> Purchase the Adapter Sleeve separately

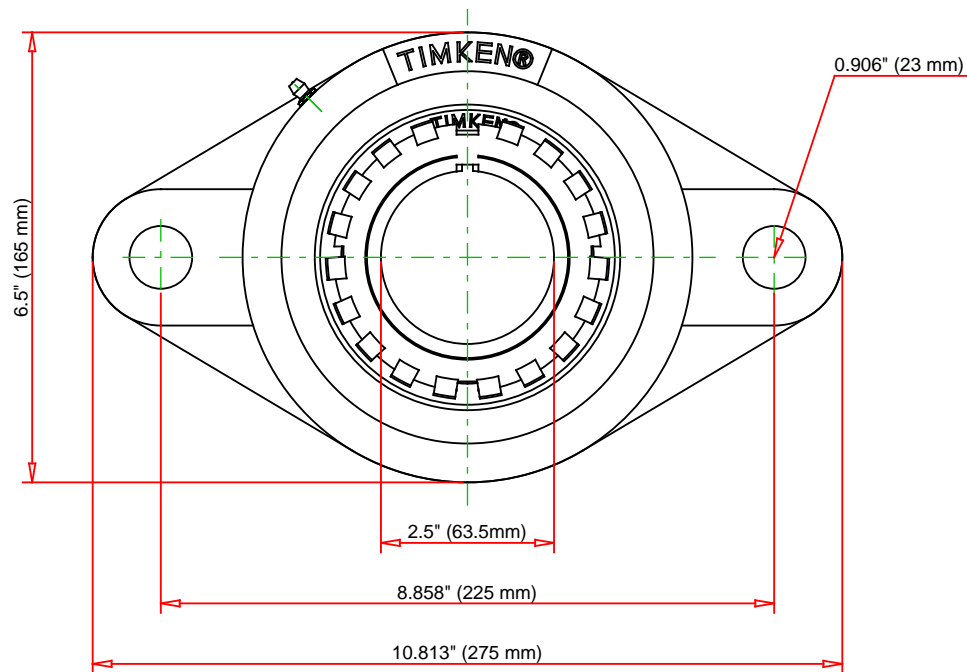
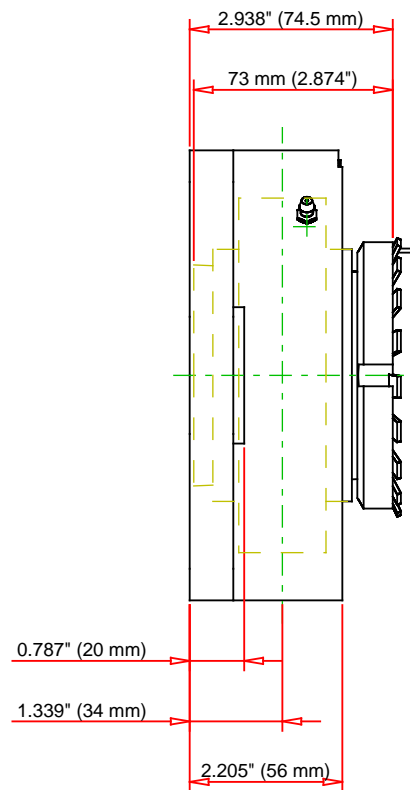

Note: Adapter sold separately

	Bearing Number	UK215 - HE2315					<div>UKFL215 - HE2315</div> <div>UKFL 200 Two-Bolt Flanged Mounted Bearings- Adapter Sleeve Locking</div>
	Load Ratings - C <sub>r</sub>	15152	lbf	67400	N		
	Load Ratings - C <sub>0r</sub>	10858	lbf	48300	N		
	Weight	14.6	lb	6.6	kg		
						THE TIMKEN COMPANY NORTH CANTON, OHIO USA	
Every reasonable effort has been made to ensure the accuracy of the information contained in this writing, but no liability is accepted for errors, omissions or for any other reason.							FOR DISCUSSION ONLY