



GRA20-XL

Flanged housing unit

Schaeffler ID:
0008896870000

Housing units GRA, three/four-bolt flanged housing units, sheet steel, eccentric locking collar, P seals

X-life

Technical information

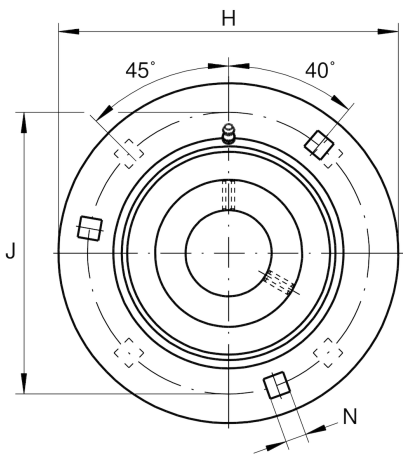

Main Dimensions & Performance Data

d	20 mm	Bore diameter
H	90.5 mm	Height flange
H	90.5 mm	Flange width
U	25.5 mm	Total height unit
B ₁	31 mm	Locking collar total width
C _{ur}	345 N	Fatigue load limit, radial
C _r	13,600 N	Basic dynamic load rating, radial
C _{0r}	6,600 N	Basic static load rating, radial
C _{0rG}	3,200 N	Load carrying capacity (housing)
	0.32 kg	Weight

Dimensions

A	8 mm	Height housing
S	2 mm	Thickness of flange
V	55 mm	Shoulder diameter housing
d ₃	37.5 mm	Outside diameter eccentric locking collar
d ₃	33 mm	Outside diameter locking collar/locknut

Mounting dimensions

J	71.5 mm	Pitch circle diameter (holes)
N	8.7 mm	Fixing square
n	3	Number of screwing holes
n	4	Number of screws

Additional information		
1		Number of housings
1		Number of housings 2
FLAN47-MSB		Housing
FLAN47-MSA		Housing (Part 2)
EXZ		Fixing
GRAE20-XL-NPP-B		Bearing designation