

Pressure Switch for Connecting to Modular/F.R.L. Units

Pressure Switch with Spacer

IS10M-30- 1 2

Semi-standard: Select one option each in **a** through **c**.
Place them in alphanumerical order.
Example) IS10M-6LP

		Symbol	Description	① Body size				
				20	30	40	50	60
②	a	Set pressure range	Nil	●	●	●	●	●
			6 Note 1)	●	●	●	●	●
	b	Lead wire length	Nil	●	●	●	●	●
			L	●	●	●	●	●
			Z	●	●	●	●	●
③	c	Scale plate pressure unit	Nil	●	●	●	●	●
			P Note 2)	●	●	●	●	●

Note 1) Set pressure range of 6P(L, Z) is 0.2 to 0.6 MPa (30 to 90 psi).

Note 2) This product is for overseas use only according to the new Measurement Law. (The SI unit type is provided for use in Japan.)

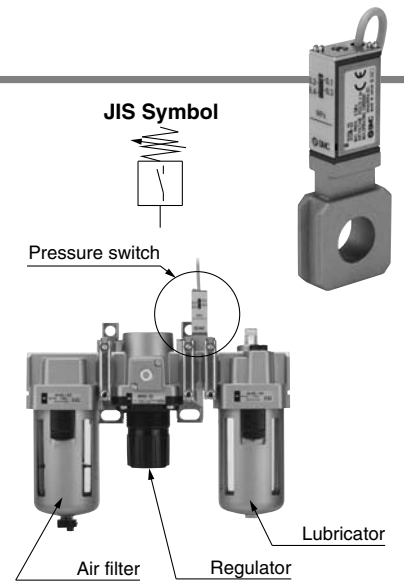
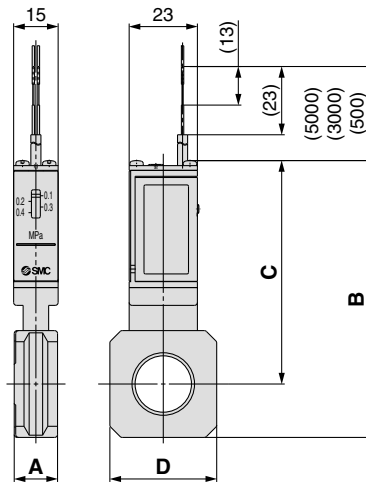

Model	A	B	C	D	Applicable model
IS10M-20	11	74	61	28	AC20□
IS10M-30	13	85	67	30	AC25□, AC30□
IS10M-40	15	93	72	36	AC40□
IS10M-50	17	97	75	44	AC40□-06
IS10M-60	22	91	64	53	AC50□, AC55□, AC60□

Note) Prepare a spacer separately for modular connection.

Pressure Switch with Piping Adapter

IS10E-30- 1 2 3 4 **03-** 5

Semi-standard: Select one option each in **a** through **d**.
Place them in alphanumerical order.
Example) IS10E-30N03-6PRZ

		Symbol	Description	① Body size		
				20	30	40
②	Thread type	Nil	Rc	●	●	●
		N	NPT	●	●	●
		F	G	●	●	●
③	Port size	01	1/8	●	—	—
		02	1/4	●	●	—
		03	3/8	●	●	●
		04	1/2	—	●	●
		06	3/4	—	—	●
④	a	Set pressure range	Nil	●	●	●
			6 Note 2)	●	●	●
	b	Lead wire length	Nil	●	●	●
			L	●	●	●
			Z	●	●	●
	c	Scale plate pressure unit	Nil	●	●	●
			P Note 1)	●	●	●
	d	Mounting position	Nil	●	●	●
			R	●	●	●

Note 1) For thread type: NPT only.

This product is for overseas use only according to the new Measurement Law. (The SI unit type is provided for use in Japan.)

Note 2) Set pressure range of 6P(L, Z) is 0.2 to 0.6 MPa (30 to 90 psi).

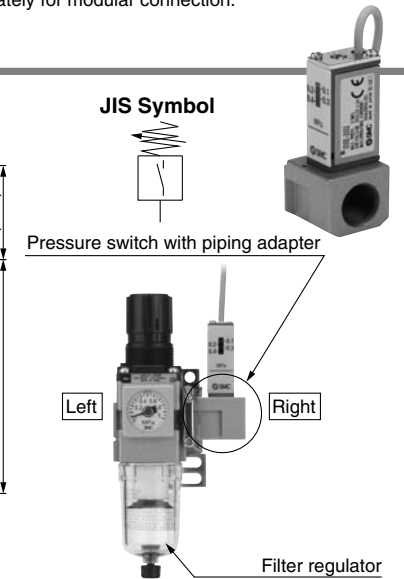
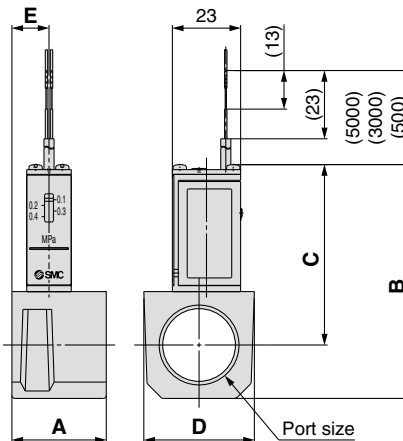

Model	Port size	A	B	C	D	E	Applicable model
IS10E-2001	1/8	30	66	52	28	16	AC20□
IS10E-2002	1/4						AR20□, AW20□
IS10E-2003	3/8						AWM20, AWD20
IS10E-3002	1/4	32	73	56	30	13	AC25□, AC30□
IS10E-3003	3/8						AR25□, AR30□, AW30□
IS10E-3004	1/2						AWM30, AWD30
IS10E-4002	1/4	32	79	58	37	13	Note 2) AC40□
IS10E-4003	3/8						AR40□, AW40□
IS10E-4004	1/2						AWM40, AWD40
IS10E-4006	3/4						

Note 1) □ in the model numbers indicates a thread type. No indication is necessary for Rc; however, indicate N for NPT, and F for G.

Note 2) Cannot be mounted to the AC40□-06 and AW40□-06.

Note 3) Prepare a spacer separately for modular connection.

* The pressure switch can be mounted on the AC40□-06 and above and the AW40□-06 by screwing the IS10-01 into the piping adapter E500-□06-X051 or E600-□06-X501 to E600-□10-X501 (Rc1/8 threaded on top surface). Products with a premounted switch are available as a special order. Please contact SMC beforehand.

For details, refer to "Modular/F.R.L. Units, Series AC" in Best Pneumatics No.5.