



The Timken Company

4500 Mt Pleasant St. NW

N. Canton, OH 44720

Phone: (234) 262-3000

E-Mail: CustomerCAD@timken.com • **Web site:** www.timken.com

Bearing Unit - Adapter Sleeve UKFL213 - H2313, UKFL 200 Two-Bolt Flanged Mounted Bearings- Adapter Sleeve Locking

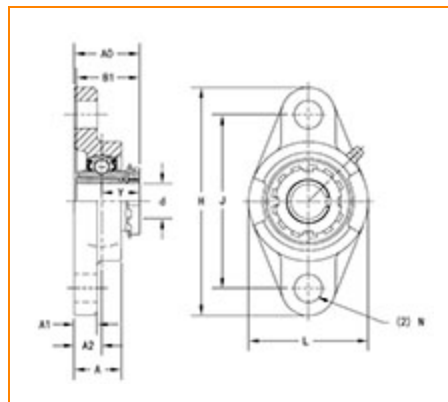

[Specifications](#) | [Dimensions](#) | [Basic Load Ratings](#)

Specifications

Bearing Unit - Adapter Sleeve	UK213 - H2313
Shaft Size d	60 mm
Adapter Sleeve Number¹	H2313
Locking Style	Adapter Sleeve Locking
Housing Construction	Two-Bolt Flange

Dimensions

Total Length H	258 mm
Total Height L	155 mm
Housing Width A	50 mm



Bolt Hole Spacing J	210 mm
Bolt Hole Size N	23 mm
Flange Thickness A1	20 mm
Center of Bearing from Housing End A2	30 mm
Center of Bearing from Bearing End Y	37.5 mm
Dimension B1	65 mm
Dimension A0	67.5 mm
Bolt Size	M20

Basic Load Ratings

Static Load Rating	40100 N
Dynamic Load Rating	57200 N

¹ Purchase the Adapter Sleeve separately

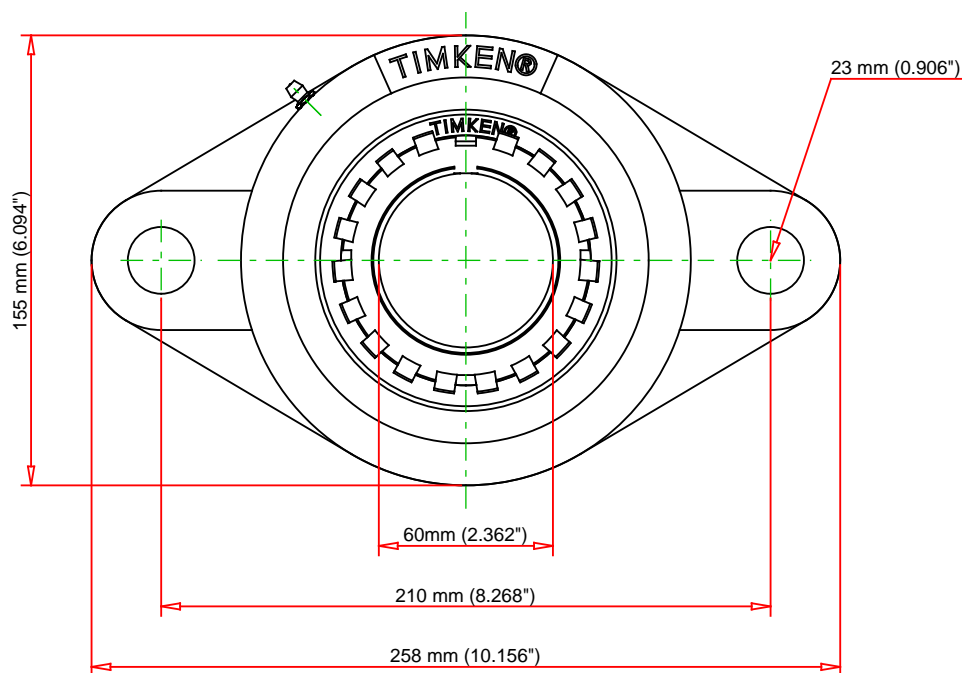

Note: Adapter sold separately

Bearing Number	UK213 - H2313		
Load Ratings - C _r	12859	lbf	57200
Load Ratings - C _{0r}	9015	lbf	40100
Weight	11	lb	5

TIMKEN®

THE TIMKEN COMPANY
NORTH CANTON, OHIO USA

UKFL213 - H2313

Every reasonable effort has been made to ensure the accuracy of the information contained in this writing, but no liability is accepted for errors, omissions or for any other reason.

FOR DISCUSSION ONLY