



The Timken Company

4500 Mt Pleasant St. NW

N. Canton, OH 44720

Phone: (234) 262-3000

E-Mail: CustomerCAD@timken.com • **Web site:** www.timken.com

Bearing Unit - Adapter Sleeve UKFL212 - H2312, UKFL 200 Two-Bolt Flanged Mounted Bearings- Adapter Sleeve Locking

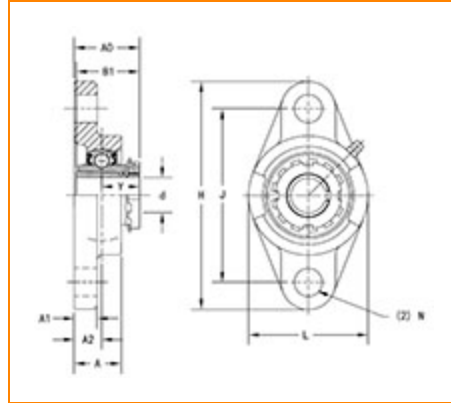

[Specifications](#) | [Dimensions](#) | [Basic Load Ratings](#)

Specifications

Bearing Unit - Adapter Sleeve	UK212 - H2312
Shaft Size d	55 mm
Adapter Sleeve Number¹	H2312
Locking Style	Adapter Sleeve Locking
Housing Construction	Two-Bolt Flange

Dimensions

Total Length H	250 mm
Total Height L	140 mm
Housing Width A	48 mm



Bolt Hole Spacing J	202 mm
Bolt Hole Size N	23 mm
Flange Thickness A1	18 mm
Center of Bearing from Housing End A2	29 mm
Center of Bearing from Bearing End Y	36.5 mm
Dimension B1	62 mm
Dimension A0	65.5 mm
Bolt Size	M20

Basic Load Ratings

Static Load Rating	36200 N
Dynamic Load Rating	52400 N

¹ Purchase the Adapter Sleeve separately

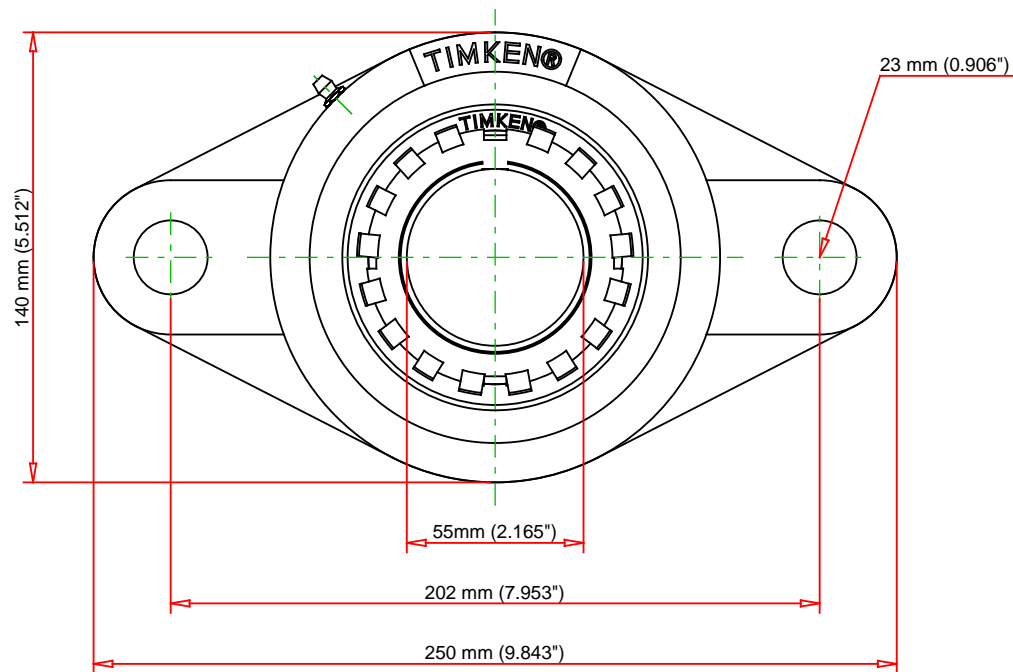
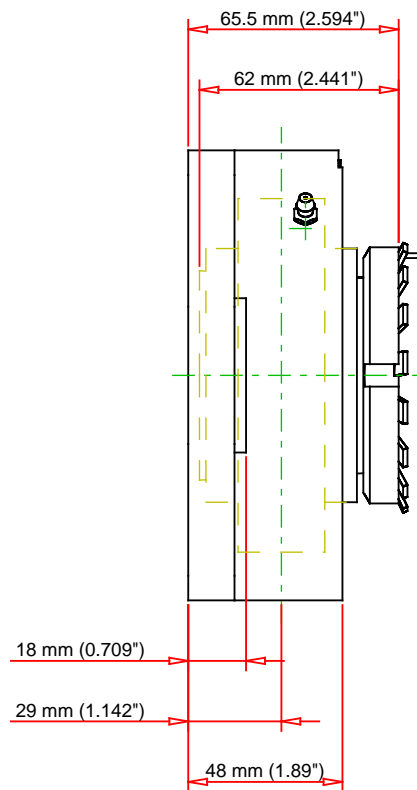

Note: Adapter sold separately

Bearing Number	UK212 - H2312			
Load Ratings - C _r	11780	lbf	52400	N
Load Ratings - C _{0r}	8138	lbf	36200	N
Weight	9	lb	4.1	kg

TIMKEN®

THE TIMKEN COMPANY
NORTH CANTON, OHIO USA

UKFL212 - H2312
UKFL 200 Two-Bolt Flanged Mounted
Bearings- Adapter Sleeve Locking

Every reasonable effort has been made to ensure the accuracy of the information contained in this writing, but no liability is accepted for errors, omissions or for any other reason.

FOR DISCUSSION ONLY