



**The Timken Company**

4500 Mt Pleasant St. NW

N. Canton, OH 44720

**Phone:** (234) 262-3000

**E-Mail:** [CustomerCAD@timken.com](mailto:CustomerCAD@timken.com) • **Web site:** [www.timken.com](http://www.timken.com)

## Part Number UCF311, UCF 300 Four-Bolt Flanged Mounted Bearings - Set Screw Locking

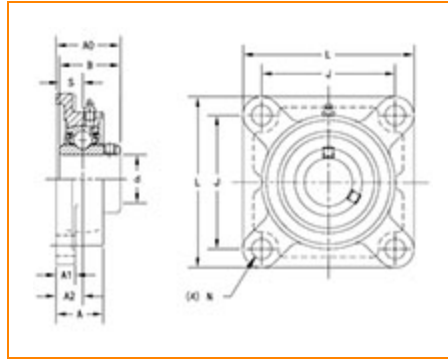

[Specifications](#) | [Dimensions](#) | [Basic Load Ratings](#)

### Specifications

<b>Bearing Number</b>	UC311
<b>Shaft Size d</b>	55 mm
<b>Locking Style</b>	Set Screw Locking
<b>Housing Construction</b>	Four-Bolt Square Flange

### Dimensions

<b>Total Length L</b>	185 mm 7.283 in
<b>Housing Width A</b>	52 mm 2.047 in
<b>Bolt Hole Spacing J</b>	140 mm 5.512 in



<b>Bolt Hole Size N</b>	23 mm 0.906 in
<b>Flange Thickness A1</b>	20 mm 0.787 in
<b>Center of Bearing from Housing End A2</b>	30 mm 1.181 in
<b>Inner Ring Width B</b>	66 mm 2.598 in
<b>Center of Bearing from Bearing End S</b>	25 mm 0.984 in
<b>Dimension A0</b>	71 mm 2.797 in
<b>Bolt Size</b>	M20
<b>Grease Nipple Size</b>	A-R1/8

## Basic Load Ratings

<b>Static Load Rating</b>	45000 N 10117 lbf
<b>Dynamic Load Rating</b>	71600 N 16096 lbf

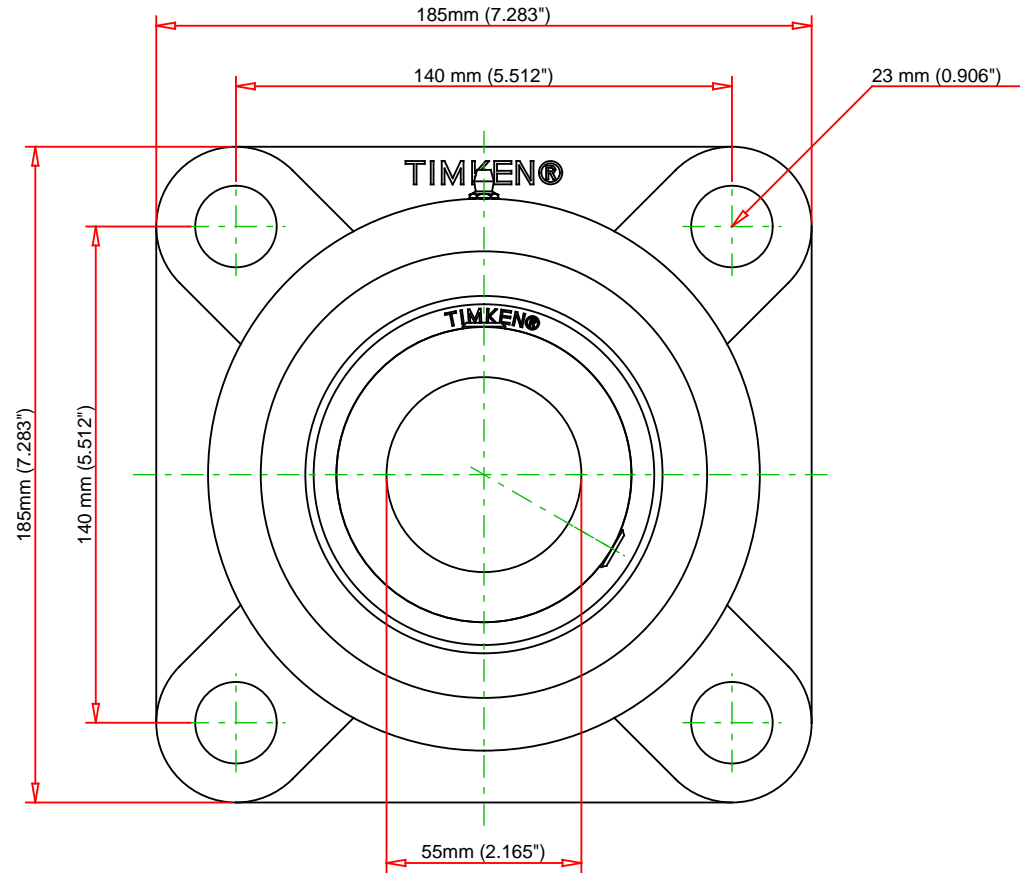

**TIMKEN**  
THE TIMKEN COMPANY  
NORTH CANTON, OHIO USA

Every reasonable effort has been made to ensure the accuracy of the information contained in this writing, but no liability is accepted for errors, omissions or for any other reason.

FOR DISCUSSION ONLY