



FAG

SES214-L

Plummer block housing

Schaeffler ID:
0956144940000

Split plummer block housing for various bearing designs. The SNV series will be replaced by the new SES series in 2022.

Technical information

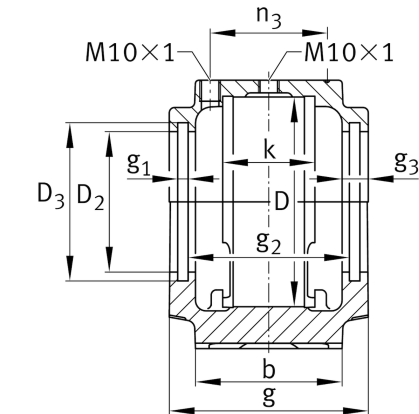
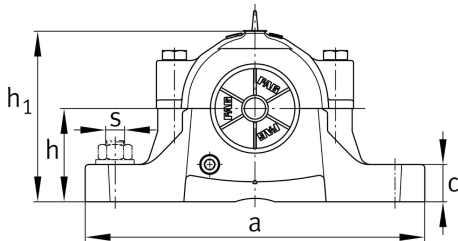
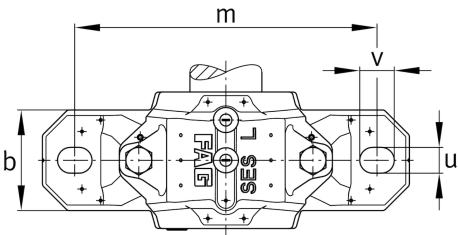

Main Dimensions & Performance Data

D	125 mm	outside diameter bearing
a	275 mm	length base
h ₁	158 mm	height
g	105 mm	width housing body
K	39 mm	Width bearing seat
	6.3 kg	Weight

Dimensions

b	80 mm	width base
c	30 mm	height base
h	80 mm	center height
m	230 mm	distance fixing bore
s	0.625	screw size
s	M16	size of fixing screws
u	18 mm	width slot
v	24 mm	length slot
D ₂	112 mm	diameter sealing
D ₃	120.5 mm	diameter sealing groove
D ₅	118.2 mm	Outside diameter sealing labyrinth
g ₁	5 mm	Width sealing groove
g ₂	84.5 mm	Distance sealing
g ₃	15 mm	Wall thickness
g ₄	45 mm	Distance oil lubrication
m ₁	190 mm	Distance holes aligned pins m1
n ₃	57 mm	Distance lubrication
n ₄	90 mm	Distance lubrication sealing
u ₁	4 mm	bore diameter u1
u ₂	14 mm	bore diameter u2