



The Timken Company

4500 Mt Pleasant St. NW

N. Canton, OH 44720

Phone: (234) 262-3000

E-Mail: CustomerCAD@timken.com • **Web site:** www.timken.com

Bearing Unit - Adapter Sleeve UKFL211 - H2311, UKFL 200 Two-Bolt Flanged Mounted Bearings- Adapter Sleeve Locking

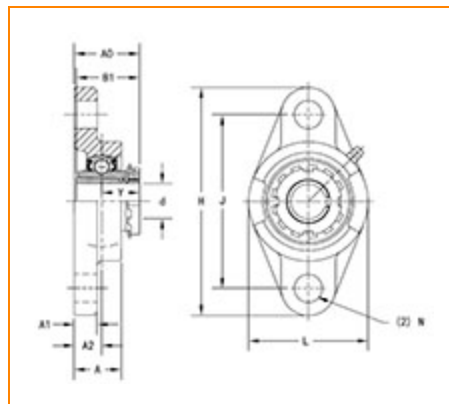

[Specifications](#) | [Dimensions](#) | [Basic Load Ratings](#)

Specifications

Bearing Unit - Adapter Sleeve	UK211 - H2311
Shaft Size d	50 mm
Adapter Sleeve Number¹	H2311
Locking Style	Adapter Sleeve Locking
Housing Construction	Two-Bolt Flange

Dimensions

Total Length H	224 mm
Total Height L	130 mm
Housing Width A	43 mm



Bolt Hole Spacing J	184 mm
Bolt Hole Size N	19 mm
Flange Thickness A1	18 mm
Center of Bearing from Housing End A2	25 mm
Center of Bearing from Bearing End Y	32 mm
Dimension B1	59 mm
Dimension A0	57 mm
Bolt Size	M16

Basic Load Ratings

Static Load Rating	29400 N
Dynamic Load Rating	43400 N

¹ Purchase the Adapter Sleeve separately

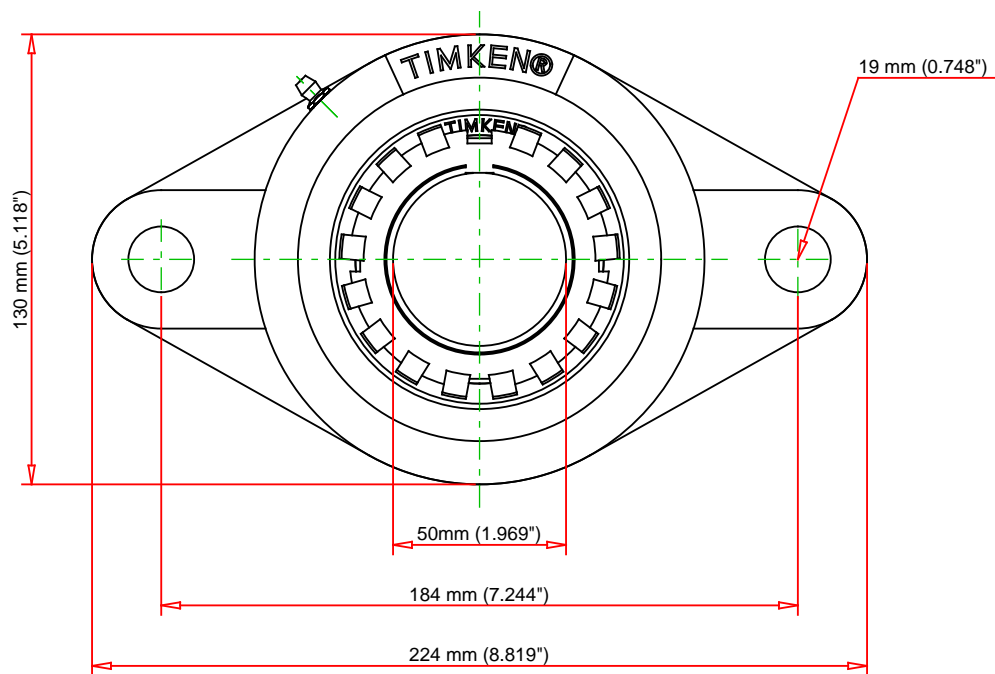
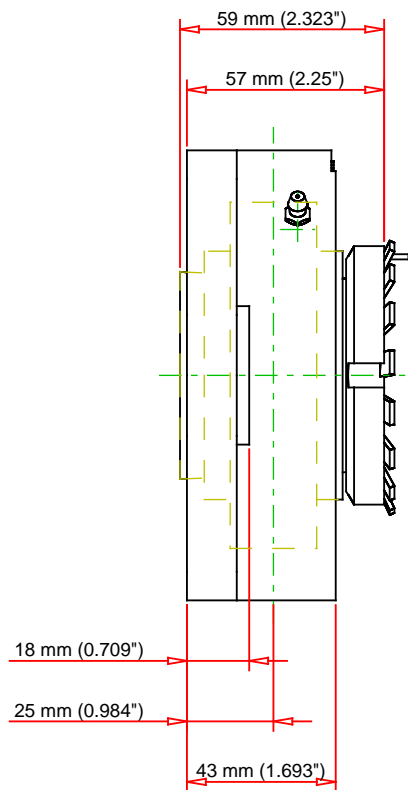

Note: Adapter sold separately

	Bearing Number		UK211 - H2311			<div>UKFL211 - H2311</div> <div>UKFL 200 Two-Bolt Flanged Mounted Bearings- Adapter Sleeve Locking</div>	
	Load Ratings - C _r		9757	lbf 43400			N
	Load Ratings - C _{0r}		6609	lbf 29400			N
	Weight		7.3	lb 3.3	kg		
Every reasonable effort has been made to ensure the accuracy of the information contained in this writing, but no liability is accepted for errors, omissions or for any other reason.						FOR DISCUSSION ONLY	