



FAG

**SES213-L**

Plummer block housing

Schaeffler ID:  
0860885050000

Split plummer block housing for various bearing designs. The SNV series will be replaced by the new SES series in 2022.

## Technical information

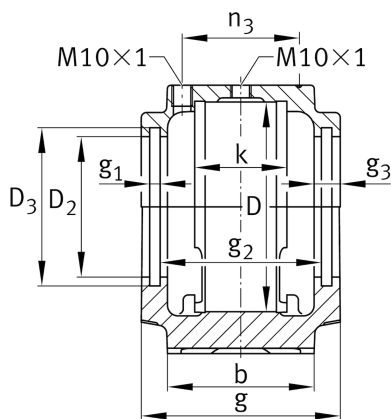
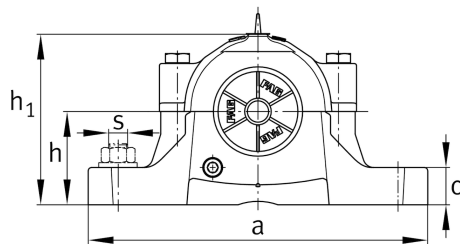
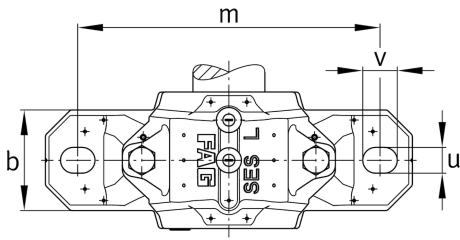
**Main Dimensions & Performance Data**

D	120 mm	outside diameter bearing
a	275 mm	length base
h <sub>1</sub>	150 mm	height
g	110 mm	width housing body
K	51 mm	Width bearing seat
	6.2 kg	Weight

**Dimensions**

b	80 mm	width base
c	30 mm	height base
h	80 mm	center height
m	230 mm	distance fixing bore
s	0.625	screw size
s	M16	size of fixing screws
u	18 mm	width slot
v	24 mm	length slot
D <sub>2</sub>	92.5 mm	diameter sealing
D <sub>3</sub>	101 mm	diameter sealing groove
D <sub>5</sub>	98.7 mm	Outside diameter sealing labyrinth
g <sub>1</sub>	5 mm	Width sealing groove
g <sub>2</sub>	92 mm	Distance sealing
g <sub>3</sub>	13 mm	Wall thickness
g <sub>4</sub>	28 mm	Distance oil lubrication
m <sub>1</sub>	194 mm	Distance holes aligned pins m1
n <sub>3</sub>	67 mm	Distance lubrication
n <sub>4</sub>	96 mm	Distance lubrication sealing
u <sub>1</sub>	6 mm	bore diameter u1
u <sub>2</sub>	14 mm	bore diameter u2