



**The Timken Company**

4500 Mt Pleasant St. NW

N. Canton, OH 44720

**Phone:** (234) 262-3000

**E-Mail:** [CustomerCAD@timken.com](mailto:CustomerCAD@timken.com) • **Web site:** [www.timken.com](http://www.timken.com)

## Bearing Unit - Adapter Sleeve UKFL209 - H2309, UKFL 200 Two-Bolt Flanged Mounted Bearings- Adapter Sleeve Locking

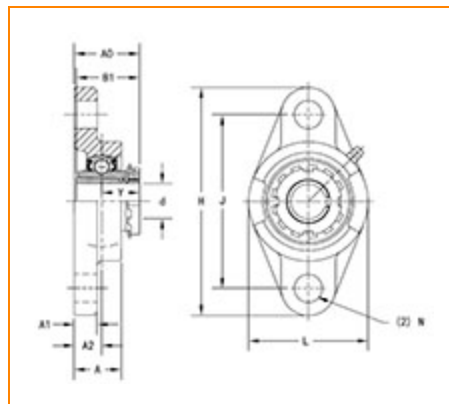

[Specifications](#) | [Dimensions](#) | [Basic Load Ratings](#)

### Specifications

<b>Bearing Unit - Adapter Sleeve</b>	UK209 - H2309
<b>Shaft Size d</b>	40 mm
<b>Adapter Sleeve Number<sup>1</sup></b>	H2309
<b>Locking Style</b>	Adapter Sleeve Locking
<b>Housing Construction</b>	Two-Bolt Flange

### Dimensions

<b>Total Length H</b>	188 mm 7.402 in
<b>Total Height L</b>	108 mm 4.252 in



<b>Housing Width A</b>	38 mm 1.496 in
<b>Bolt Hole Spacing J</b>	148 mm 5.827 in
<b>Bolt Hole Size N</b>	19 mm 0.748 in
<b>Flange Thickness A1</b>	15 mm 0.591 in
<b>Center of Bearing from Housing End A2</b>	22 mm 0.866 in
<b>Center of Bearing from Bearing End Y</b>	29 mm 1.142 in
<b>Dimension B1</b>	50 mm 1.969 in
<b>Dimension A0</b>	51 mm 2 in
<b>Bolt Size</b>	M16

## Basic Load Ratings

<b>Static Load Rating</b>	21300 N 4788 lbf
<b>Dynamic Load Rating</b>	34100 N 7666 lbf

<sup>1</sup> Purchase the Adapter Sleeve separately

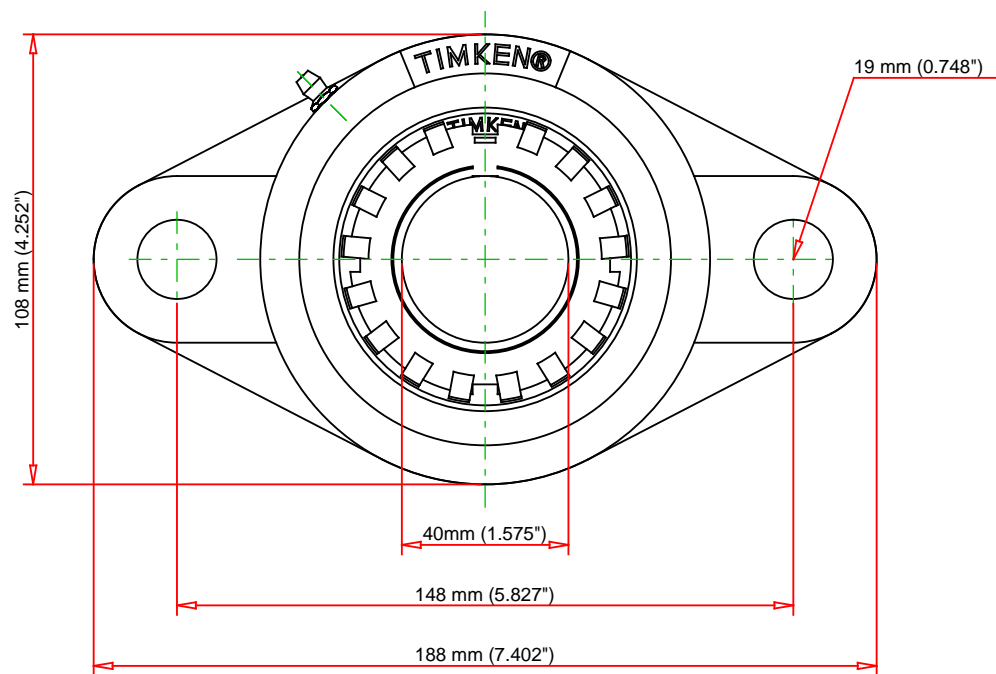
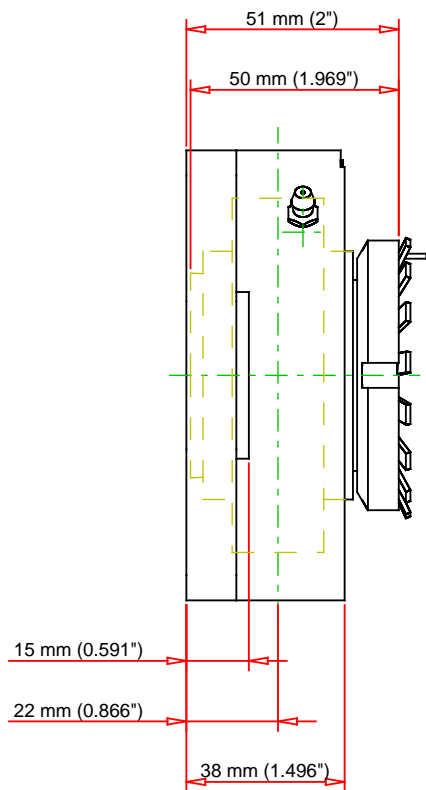

Note: Adapter sold separately

	Bearing Number	UK209 - H2309					<b>UKFL209 - H2309</b> UKFL 200 Two-Bolt Flanged Mounted Bearings- Adapter Sleeve Locking
	Load Ratings - C <sub>r</sub>	7666	lbf	34100	N		
	Load Ratings - C <sub>0r</sub>	4788	lbf	21300	N		
	Weight	4.4	lb	2	kg		
						THE TIMKEN COMPANY NORTH CANTON, OHIO USA	

Every reasonable effort has been made to ensure the accuracy of the information contained in this writing, but no liability is accepted for errors, omissions or for any other reason.

FOR DISCUSSION ONLY