



**The Timken Company**

4500 Mt Pleasant St. NW

N. Canton, OH 44720

**Phone:** (234) 262-3000

**E-Mail:** [CustomerCAD@timken.com](mailto:CustomerCAD@timken.com) • **Web site:** [www.timken.com](http://www.timken.com)

## Bearing Unit - Adapter Sleeve UKFL208 - H2308, UKFL 200 Two-Bolt Flanged Mounted Bearings- Adapter Sleeve Locking

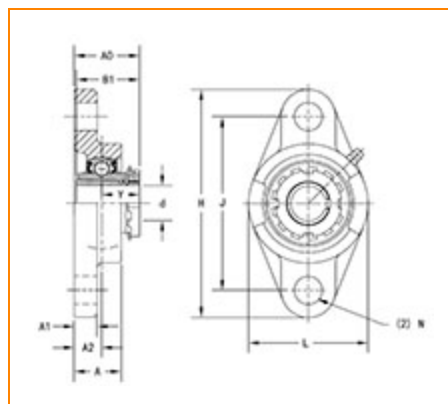

[Specifications](#) | [Dimensions](#) | [Basic Load Ratings](#)

### Specifications

<b>Bearing Unit - Adapter Sleeve</b>	UK208 - H2308
<b>Shaft Size d</b>	35 mm
<b>Adapter Sleeve Number<sup>1</sup></b>	H2308
<b>Locking Style</b>	Adapter Sleeve Locking
<b>Housing Construction</b>	Two-Bolt Flange

### Dimensions

<b>Total Length H</b>	175 mm
<b>Total Height L</b>	100 mm
<b>Housing Width A</b>	36 mm



<b>Bolt Hole Spacing J</b>	144 mm
<b>Bolt Hole Size N</b>	16 mm
<b>Flange Thickness A1</b>	14 mm
<b>Center of Bearing from Housing End A2</b>	21 mm
<b>Center of Bearing from Bearing End Y</b>	27 mm
<b>Dimension B1</b>	46 mm
<b>Dimension A0</b>	48 mm
<b>Bolt Size</b>	M14

#### Basic Load Ratings

<b>Static Load Rating</b>	17800 N
<b>Dynamic Load Rating</b>	29100 N

<sup>1</sup> Purchase the Adapter Sleeve separately

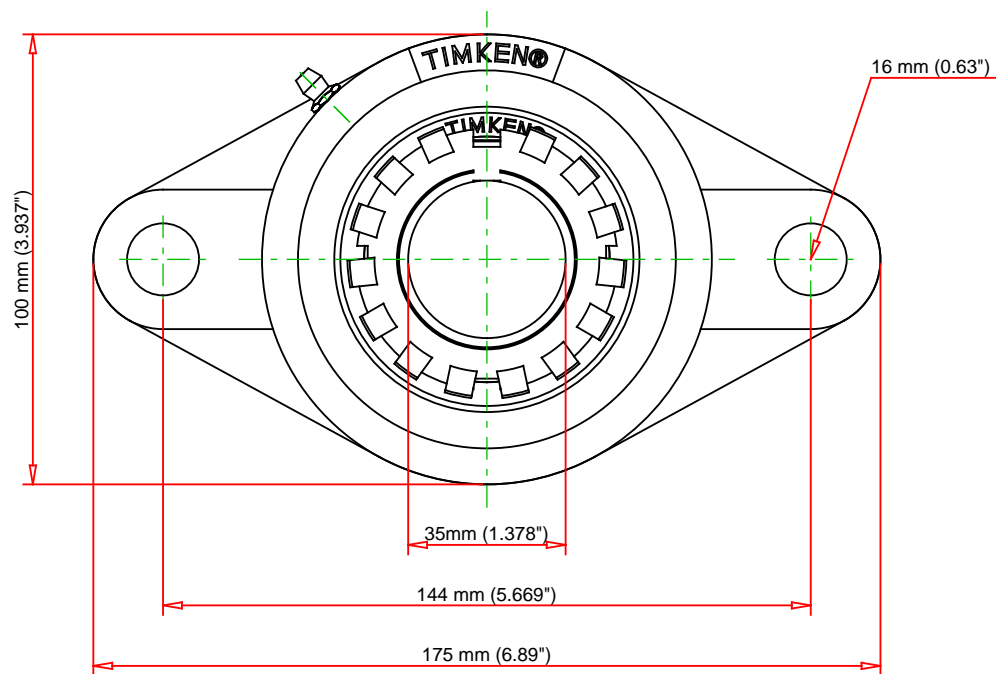
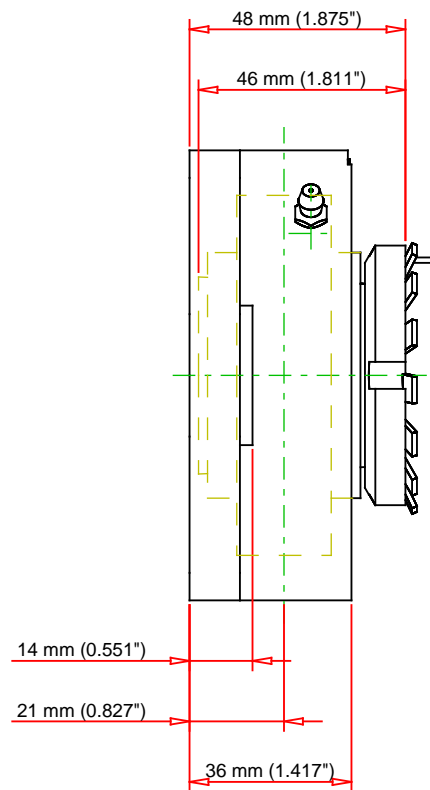

Note: Adapter sold separately

Bearing Number	UK208 - H2308			
Load Ratings - C <sub>r</sub>	6542	lbf	29100	N
Load Ratings - C <sub>0r</sub>	4002	lbf	17800	N
Weight	3.5	lb	1.6	kg

**TIMKEN**

THE TIMKEN COMPANY  
NORTH CANTON, OHIO USA

**UKFL208 - H2308**  
UKFL 200 Two-Bolt Flanged Mounted  
Bearings- Adapter Sleeve Locking

Every reasonable effort has been made to ensure the accuracy of the information contained in this writing, but no liability is accepted for errors, omissions or for any other reason.

**FOR DISCUSSION ONLY**